

# McLean County Clerk's Office

## Normal Township

### Voting Precincts Map

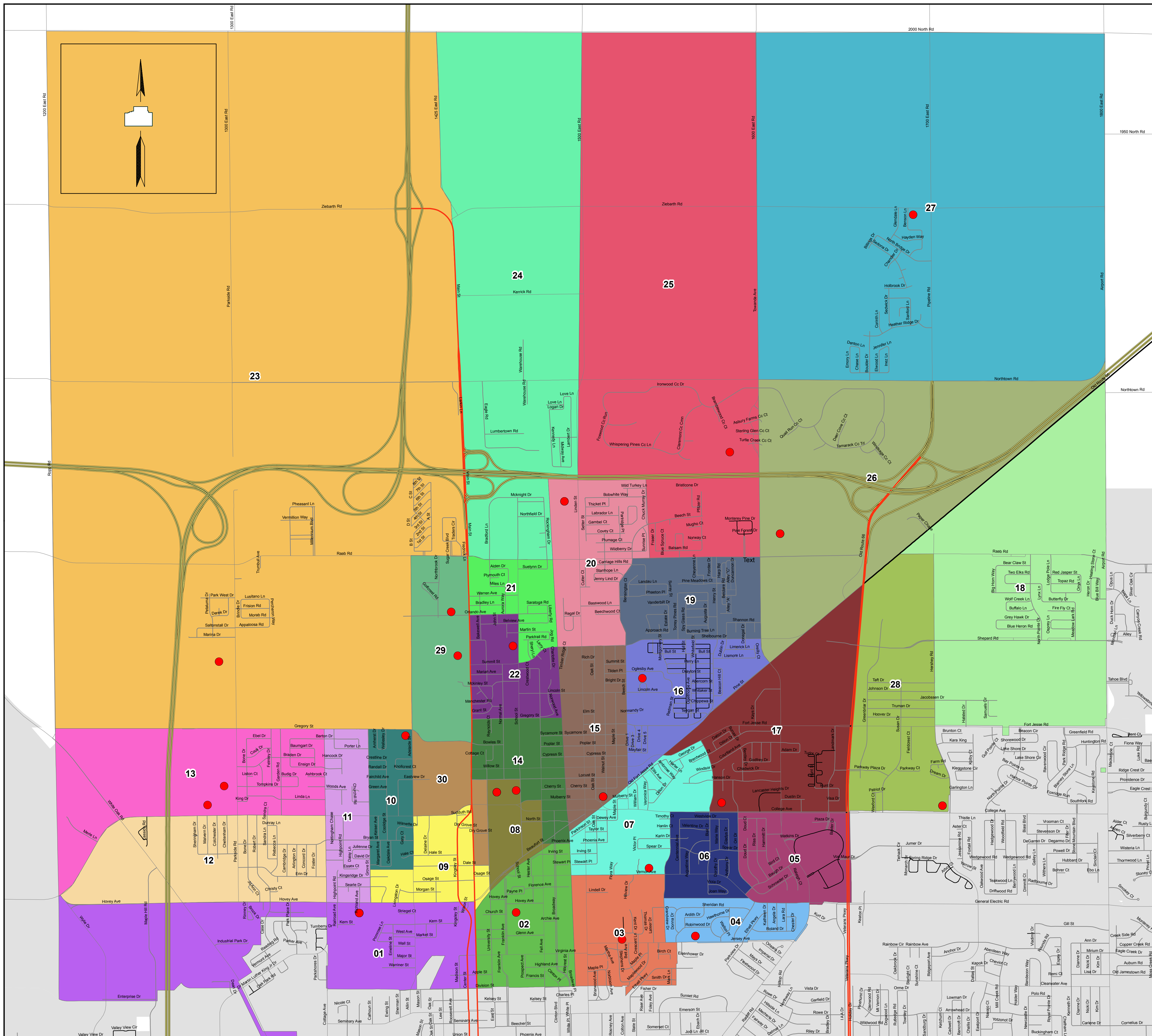

3001 Normal 01	Grace Church 1311 W Hovey Avenue Normal, IL 61761
3002 Normal 02	Franklin Avenue Medical Center 900 Franklin Avenue Normal, IL 61761
3003 Normal 03	Jacob's Well 304 Jersey Avenue Normal, IL 61761
3004 Normal 04	New Vision Church of God 814 Jersey Avenue Normal, IL 61761
3005 Normal 05	New Vision Church of God 814 Jersey Avenue Normal, IL 61761
3006 Normal 06	First Assembly of God Church 800 E Vernon Avenue Normal, IL 61761
3007 Normal 07	Normal Township Hall 304 E Mulberry Street Normal, IL 61761
3008 Normal 08	ISU Bone Student Center 100 N University Street Normal, IL 61761
3009 Normal 09	Grace Church 1311 W Hovey Avenue Normal, IL 61761
3010 Normal 10	Evergreen Place 801 Gregory Street Normal, IL 61761
3011 Normal 11	Grace Church 1311 W Hovey Avenue Normal, IL 61761
3012 Normal 12	Parkside Elementary School 1900 W College Avenue Normal, IL 61761
3013 Normal 13	Parkside Jr. High School 101 N Parkside Drive Normal, IL 61761
3014 Normal 14	First United Methodist Church 211 N School Street Normal, IL 61761
3015 Normal 15	Normal Township Hall 304 E Mulberry Street Normal, IL 61761
3016 Normal 16	Community Activity Center 1 Normal Plaza - 1110 Douglas Street Normal, IL 61761
3017 Normal 17	College Avenue Baptist Church 1320 E. College Avenue Normal, IL 61761
3018 Normal 18	First Presbyterian Church 2000 E College Ave. Normal, IL 61761
3019 Normal 19	Calvary United Methodist Church 1700 N Towanda Avenue Normal, IL 61761
3020 Normal 20	Heartland Community Church 1811 N Linden Street Normal, IL 61761
3021 Normal 21	McLean County Nursing Home 901 N Main Street Normal, IL 61761
3022 Normal 22	Calvary Baptist Church 1017 N School Street Normal, IL 61761
3023 Normal 23	Normal Community West HS 501 N Parkside Drive Normal, IL 61761
3024 Normal 24	Heartland Community Church 1811 N Linden Street Normal, IL 61761
3025 Normal 25	Ironwood Club House 1901 N Towanda Avenue Normal, IL 61761
3026 Normal 26	Calvary United Methodist Church 1700 N Towanda Avenue Normal, IL 61761
3027 Normal 27	North Bridge Baptist Church 2413 Ziebarth Rd Normal, IL 61761
3028 Normal 28	First Presbyterian Church 2000 E College Ave. Normal, IL 61761
3029 Normal 29	Normal Police Department Substation 632 Orlando Ave Normal, IL 61761
3030 Normal 30	ISU Bone Student Center 100 N University St Normal, IL 61761



McLEAN COUNTY CLERK'S OFFICE  
Peggy Ann Milton - County Clerk  
115 E Washington Street, Room 102  
Bloomington, IL 61702-2400  
Phone (309) 888-5190  
Fax (309) 888-5932

