



PROPERTY COMMITTEE AGENDA
Room 700, Law and Justice Center

Thursday, October 2, 2003

3:00 P.M.

1. Roll Call.
2. Chairman's Approval of Minutes – September 4, 2003
3. Departmental Matters:
 - A. Jack Moody, Facilities Manager
 - 1) Items to be presented for Action:
 - a) Request Approval of a Preliminary Parking Lot Layout for Health Department Parking Lot and West side of the Law and Justice Center 1 - 3
 - b) Request for Approval of Revised Tenant Lease Agreements for: 4
 - 1) Regional Office of Education for McLean, DeWitt and Livingston Counties – (Fairview) 5 - 17
 - 2) G.E.D. Adult Education Literacy Program – (Fairview) 18 - 29
 - 3) YWCA of McLean County – (Fairview) 30 - 42
 - 4) Bloomington Board of Election Commissioners (McLean County Health Department) 43 - 54
 - 5) Children's Advocacy Center – (McLean County Health Department) 55 - 67
 - 6) McLean County State's Attorney – (McLean County Health Department) 68 - 80
 - 2) Items to be presented for Information:
 - a) Status Report on the Repairs and Renovation to the Law and Justice Center
 - b) Status Report on Exterior Envelope Replacement at 200 West Front Street –

- c) Health Department
Status Report on the Illinois Public Museum
Capital Grant Project at McLean County
Museum of History
- d) Status Report on City of Bloomington
Township Assessor's Office Space
- e) Status Report on Lincoln Parking Deck
- f) General Report
- g) Other

C. John Zeunik, County Administrator

1) Items to be presented for Action:

a) Review of Fiscal Year 2004 Recommended
Budget:

- 1) Parks and Recreation Department 81 - 84
- 2) Evergreen Lake Lease Fund 85 - 87
- 3) Facilities Management Department
 - a) Juvenile Detention Center
Program 88 - 91
 - b) MetCom Center Program 92 - 95
 - c) 200 West Front Street and
Health Department Building 96 - 99
 - d) Old County Courthouse
Program 100 - 103

2) Items to be presented for Information:

- a) General Report
- b) Other

4. Other Business and Communications

5. Recommend Payment of Bills and Transfers, if any, to County Board

6. Adjournment

young architects 211 prospect box 14884 bloomington, il. 61704 6814-13774

Mr. Jack Moody - Director
McLean County Facilities Management
Law and Justice Center
104 W. Front
Bloomington, IL. 61701

RECEIVED
SEP 22 2003
Facilities Mgt. Div.

Jack

Attached is an 8 1/2" x 11" print of the proposed revision of the parking lot on the west side of the Law and Justice Center, originally created to locate the new transformers and the new generator with this possible parking layout in mind.

Also attached is a print of the existing parking area for reference.



Gene Asbury, Young Architects.

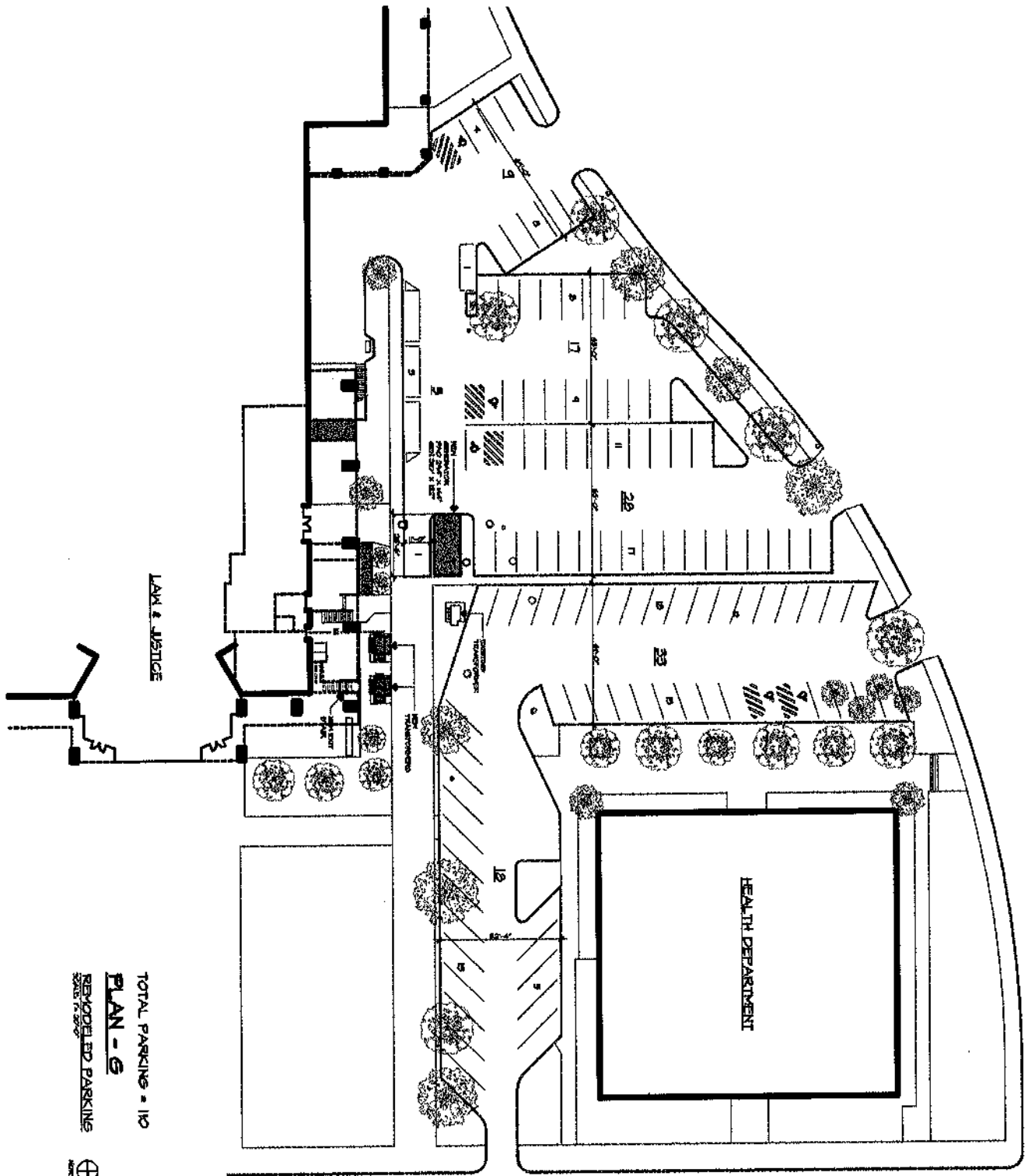

TOTAL PARKING = 10
PLAN - G
 RENOVATED PARKING
 SCALE: 1/8" = 1'-0"



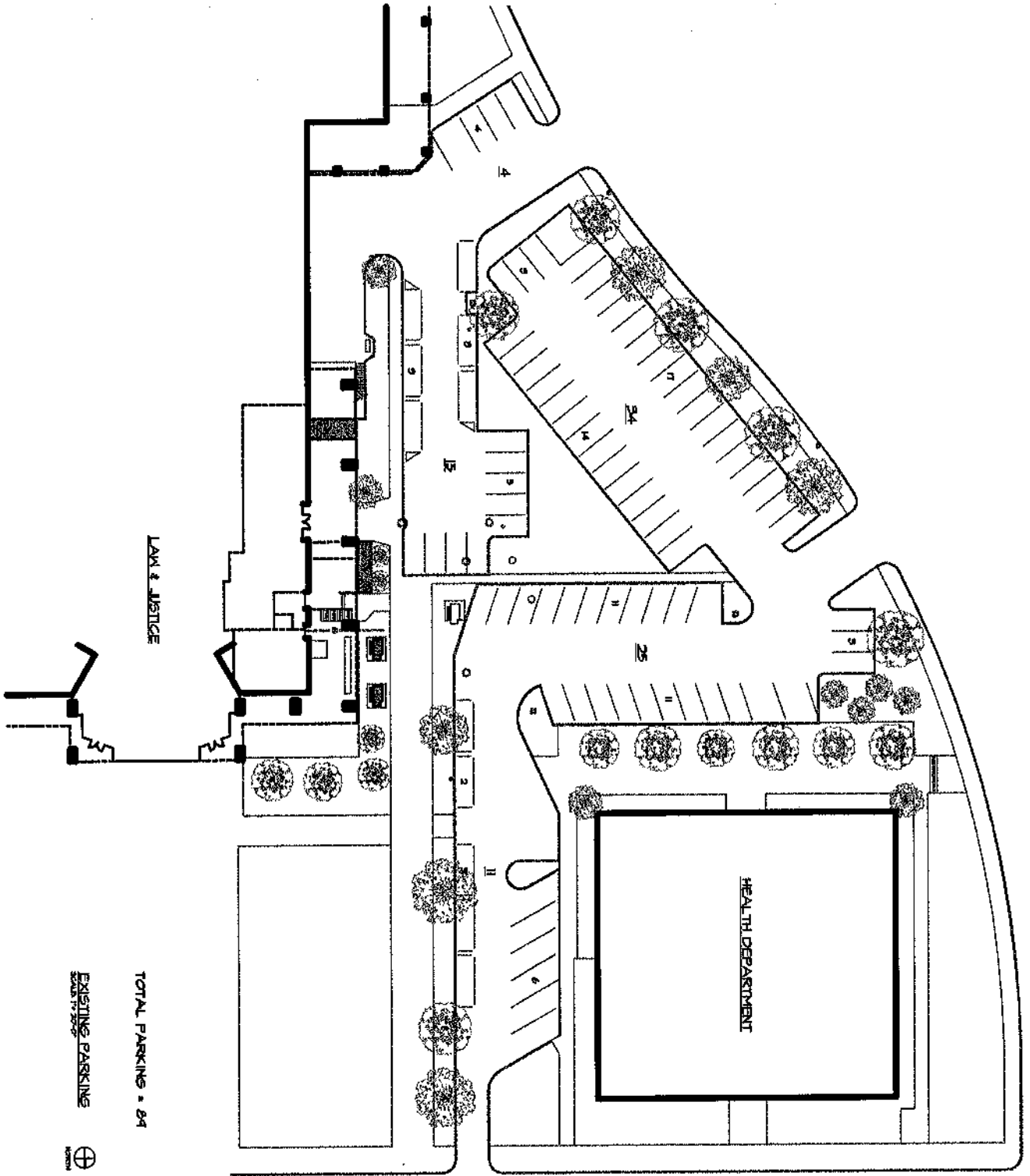

TOTAL PARKINGS = 84

EXISTING PARKINGS



YOUNG ARCHITECTS
 1000 West 10th St.
 Suite 100
 Anchorage, AK 99501
 Phone: 907.562.1234
 Fax: 907.562.1235
 E-mail: info@youngarchitects.com

PROJECT:
 LAW & JUSTICE REPAIR
 ARCHITECT:
 YOUNG ARCHITECTS
 DATE:
 07/14/03
 SHEET NO.:
 C-1.0



FACILITIES MANAGEMENT
(309) 888-5192 FAX (309) 888-5209
104 W. Front P.O. Box 2400 Bloomington, Illinois 61702-2400

To: Honorable Chairman and Members of the Property Committee
Mr. John M. Zeunik, County Administrator

From: Jack E. Moody, CFM
Director, Facilities Management

Date: September 24, 2003

Subj: **Renewal of Tenant Leases for 2004**

Attached for your kind review and consideration please find five tenant lease renewals for the year 2004. The current leases will expire on December 31, 2003. The tenants whose leases will expire at the end of this year include:

Fairview Building:

Regional Office of Education for McLean/DeWitt/Livingston Counties
G.E.D. Adult Education Literacy Program
YWCA of McLean County

McLean County Health Department Building:

Bloomington Board of Election Commissioners
Children's Advocacy Center (CAC)

We have budgeted in the Recommended McLean County Budget for FY 2004 the lease dollars contained in the attached lease renewals. Mr. Eric Ruud, First Assistant States Attorney, has reviewed these leases and states they are consistent with prior lease agreements.

We, therefore, request and recommend approval of the Property Committee of the attached lease renewals for these tenants, and that this matter be placed as an action agenda item for the October 21, 2003, McLean County Board meeting. Thank you for your kind consideration of this matter.

JEM
Enclosures

Leases.Doc

LEASE AGREEMENT

Between

The County of McLean

As Landlord

And

**Regional Office of Education for McLean/
DeWitt/Livingston Counties**

As Tenant,

For

**Office Space Located in
905 N. Main Street, Normal, Illinois**

Table of Contents

	<u>Page</u>
1. <u>Term.</u>	1
2. <u>Rent.</u>	1
3. <u>Capital Improvement Fund.</u>	1
4. <u>Tenant's Use and Operation.</u>	2
5. <u>Building Common Areas.</u>	2
6. <u>Maintenance and Repair.</u>	2
7. <u>Parking.</u>	3
8. <u>Alterations.</u>	3
9. <u>Insurance and Indemnity.</u>	3
10. <u>Conduct.</u>	4
11. <u>Signs.</u>	4
12. <u>Estoppel.</u>	5
13. <u>Access to Premises.</u>	5
14. <u>Hazardous Material.</u>	5
15. <u>Condemnation.</u>	6
16. <u>Destruction.</u>	6
17. <u>Insolvency.</u>	6
18. <u>Assignment and Subletting.</u>	7
19. <u>Default.</u>	7
20. <u>Termination; Surrender of Possession.</u>	7
21. <u>Waiver.</u>	8

22. <u>Notices.</u>	8
23. <u>Agency.</u>	9
24. <u>Partial Invalidity.</u>	9
25. <u>Holding Over.</u>	9
26. <u>Successors.</u>	9
27. <u>Right to Terminate.</u>	10
28. <u>Non-Affiliation Clause.</u>	10
Approval Signatures	10

Lease Agreement

WHEREAS, the County of McLean, a body corporate and politic, (hereinafter referred to as "COUNTY"), as landlord, and the Regional Office of Education for McLean/DeWitt, and Livingston Counties, (hereinafter referred to as "ROE"), as tenant, desire to continue a lease agreement for office space consisting of 5,224 s.f. located on the first floor and 5,541 s.f. of office space located on the second floor or a total of 10,765 s.f. of office space in the Fairview Building, 905 N. Main Street, Normal, Illinois, (hereinafter referred to as "BUILDING"), in accordance with Illinois Compiled Statutes 105 ILCS 5/4-2 requiring COUNTY, as the host County, to provide office space for ROE; and,

WHEREAS, this lease agreement expressly sets forth the rights and duties of each party,

NOW THEREFORE, it is expressly agreed as follows:

1. **Term.** The term of the lease agreement shall commence on January 1, 2004, and terminate on December 31, 2004.

2. **Rent.**
 - a. ROE shall be provided 6,860 s.f., or 64% (percent) of the 10,765 s.f. amount for an annual maintenance and operating expense of \$39,078.25. The McLean County Auditor's Office shall calculate and present to ROE a monthly statement for the payment of this expense by ROE representing ROE's proportionate share of all utilities, (including electric, gas, water, and trash removal), maintenance, cleaning supplies, and maintenance equipment service contracts. Furthermore, ROE agrees to pay COUNTY a monthly rent payment of \$200.00 per month to the Capital Improvement Replacement Fund for BUILDING.

 - b. All rent payments shall be mailed to the below address:

**McLean County Treasurer
104 W. Front Street, Suite 706
Bloomington, Illinois 61702-2400**

 - c. The monthly rent payment during each month of the term of the lease shall be due and payable commencing on the first day of each month.

3. **Capital Improvement Fund.** All monies paid into this FUND by ROE shall be reserved by COUNTY to pay for major capital improvement replacement expenses for BUILDING. A major capital improvement replacement expense shall be defined as follows:
 - a. Additions and/or renovations to BUILDING and the adjacent property;

- b. Capital equipment purchases for mechanical, electrical, and HVAC equipment servicing BUILDING;
- b. Capital equipment and fixtures purchases for BUILDING with a depreciated life expectancy greater than seven (7) years.

In the event COUNTY determines that a major capital improvement replacement expense is necessary and the capital improvement replacement fund is not sufficient to fully fund 100% of the expense, COUNTY agrees to pay for the major capital improvement replacement expense from other COUNTY sources. COUNTY and ROE agree that COUNTY shall then be reimbursed for this expense over time from the funds on deposit in the capital improvement replacement fund.

- 4. **Tenant's Use and Operation.** ROE shall use the aforementioned leased premises only for the purposes of its general business office. ROE shall not use the premises for any unlawful, improper, or immoral use, nor for any purpose or in any manner which is in violation of any present or future governmental law or regulation. ROE shall, during the term of the lease agreement, continuously use the leased premises for the purposes stated herein.
- 5. **Building Common Areas.** ROE shall be entitled to use of the areas designated from time to time by COUNTY as "common areas", and which are adjacent to or benefit the leased premises. Such common areas shall include adjoining sidewalks, entryway lobby, and lobby atrium areas for the purpose of egress and ingress of ROE employees and clients. Such use shall be subject to the rules and regulations, as COUNTY shall from time to time issue.
- 6. **Maintenance and Repair.** COUNTY shall be responsible for compliance with all building codes, the American's with Disabilities Act (as to permanent improvements only) and any other environmental or building safety issues and any state, local, and federal regulations relating thereto, perform all general building maintenance and repair. Notwithstanding the foregoing, COUNTY shall not be responsible for the cost of repairs and maintenance caused by intentional acts or negligence of ROE employees, agents, or clients. ROE shall keep the interior of premises as well as any portion of the leased premises visible from the exterior clear, orderly, and in good condition and repair, at its own expense. ROE shall keep all glass areas of leased premises clean which are visible from the BUILDING common area hallways. ROE shall be responsible for their own custodial needs, equipment, and supplies and the replacement cost of ceiling mounted light fixture lamps.

Page three

7. **Parking.** ROE is permitted use of the adjacent parking lot of BUILDING for its employees and clients, on a first-come, first-served basis. Parking stalls shall not be assigned. Furthermore, ROE agrees and understands that other tenants and COUNTY offices also use said parking located at BUILDING, and that ROE agrees not to park in the parking lot of the nearby McLean County Nursing Home nor the McLean County Juvenile Detention Center.

8. **Alterations.** No alterations, additions, or improvements shall be made in or to the leased premises by ROE without the prior express written approval of COUNTY. All alterations, additions, improvements, and fixtures which may be made or installed by either of the parties hereto upon the leased premises and which in any manner are attached to the floors, walls, or ceiling, with the exception of ROE displays and trade fixtures, shall be the property of COUNTY and at the termination of this lease shall remain upon and be surrendered with the leased premises as a part thereof, without disturbance, molestation or injury. Notwithstanding the foregoing, COUNTY may designate by written notice to ROE certain fixtures, trade fixtures, alterations and additions to the leased premises which shall be removed by ROE at the expiration of this lease agreement. The parties hereto may also agree in writing, prior to the installation or construction of any alterations, improvements, or fixtures to the leased premises by ROE that ROE may either cause the removal of such items at the time of expiration of this lease, or that they may be left in the leased premises. ROE shall, at its own expense, repair any damages to the leased premises caused by the removal of its fixtures or alterations.

9. **Insurance and Indemnity.**
 - a. **Covenants to Hold Harmless.** ROE agrees to save and hold harmless COUNTY (including its officials, agents, and employees) free and harmless from all liability, public or private, penalties, contractual or otherwise, losses, damages, costs, attorney's fees, court costs, expenses, causes of action, claims or judgements, resulting from claimed natural persons and any other legal entity, or property of any kind (including, but not limited to choses in action) arising out of or in any way connected with this undertaking, whether or not arising out of the partial or sole negligence of COUNTY or its officials, agents, or employees, and shall indemnify COUNTY from any costs, expenses, judgements, and attorney's fees paid or incurred by or on behalf of COUNTY and/or its agents and employees.

 - b. **Fire and Casualty Insurance.** COUNTY shall be responsible for obtaining and maintaining a policy of fire and casualty insurance with extended coverage provisions applicable to the leased premises and protecting COUNTY against loss due to the structure of the premises. ROE shall be responsible for obtaining and maintaining a policy for fire and casualty insurance protecting ROE against loss or damage to its furnishings, equipment, and personal property in or on the leased premises.

Page four

- c. **Added Risk.** ROE shall also pay any increase in the fire and casualty insurance rates or premiums on the leased premises caused by any increased risk or hazardous business carried on by ROE in the leased premises. The determination of the insurance carrier shall be binding upon the parties as to the added risk resulting from ROE business. ROE's share of the annual insurance premiums for such insurance, as required by this paragraph, shall be paid within ten (10) days after ROE is given written request for same. COUNTY shall bill ROE without notice or negotiation for any rate increase.
- d. **Obligation to Carry Public Liability Insurance.** ROE shall, during the entire term hereof, keep in full force a policy of public liability insurance with respect to the leased premises and the business operated by ROE in the leased premises, and in which the limits of liability shall not be less than One Million Dollars (\$1,000,000.00), for personal injuries to any person or persons arising out of a single accident and Five Hundred Thousand Dollars (\$500,000.00) for property damage resulting from any one occurrence. COUNTY shall be named as an additional insured in all policies of liability insurance maintained pursuant to this provision. ROE shall furnish COUNTY a Certificate of Insurance of evidence of insurance that such insurance is in force at all times during the term of the lease. ROE shall furnish COUNTY additional certificates of ROE's insurance within twenty (20) days of receipt of a written request from COUNTY for such certificate.

Insurance shall be in a form acceptable to COUNTY and written by an insurance company admitted in the state of Illinois for such coverage.

- e. **Waiver of Subrogation Rights Under Insurance Policies.** Notwithstanding anything to the contrary contained herein, each of the parties hereto releases the other, and other tenants in BUILDING, to the extent of each party's insurance coverage, from any liability for any loss or damage which may be inflicted upon the property of such party even if such loss or damage shall be brought about by the fault or negligence of the other party, or other tenants, or their agents, employees or assigns; provided, however, that this release shall be effective only with respect to loss or damage occurring during such time as the appropriate policy of insurance contains a clause to the effect that this release shall not affect the policy or the right of the insured to recover thereunder.
10. **Conduct.** ROE shall not cause or permit any conduct to take place within the leased premises which in any way disturbs or annoys other tenants or occupants of BUILDING, or adjacent buildings.
11. **Signs.** No sign, banner, decoration, picture, advertisement, awning, merchandise, or notice on the outside of leased premises or BUILDING, or which can be seen from the outside of leased premises, shall be installed or maintained by ROE without the prior express written approval of COUNTY.

12. **Estoppel.** Each party, within ten (10) days after notice from the other party, shall execute to the other party, in recordable form, a certificate stating that this lease is unmodified and in full force and effect, or in full force and effect as modified, and stating the modifications. The certificate shall also state the number of the base rental, the date to which the rent has been paid in advance, and the amount of any security deposit or prepaid rent. Failure to deliver the certificate within the ten (10) days shall be conclusive upon the party failing to so deliver for the benefit of the party requesting the certificate and any successor to the party so requesting, that this lease is in full force and effect and has not been modified except as may be represented by the party requesting the certificate.

13. **Access to the Premises.** COUNTY shall have the right to enter upon the leased premises at anytime for the purpose of inspecting the same, or of making repairs, or alternations to the leased premises or any property owned or controlled by COUNTY. For a period commencing one hundred twenty (120) days prior to the termination of this lease, COUNTY may have reasonable access to the leased premises for the purpose of exhibiting the same to prospective tenants.

14. **Hazardous Material.**
 - a. **Prohibition.** ROE expressly covenants and agrees that it will not cause or permit to be brought to, produced upon, disposed of or stored at the leased premises an hazardous material. For purposes of this provision, hazardous material shall mean any substance, in any form which is regulated or prohibited by statute, regulation, ordinance or rule including, but not limited to the Comprehensive Environmental Response, Comprehensive and Liability Act, 42 USC 6901, *et seq.* and regulations promulgated thereunder; the Toxic Substances Control Act, 15 USC 2601, *et seq.* and regulations promulgated thereunder; of the state of Illinois statutes; or any substance which may be harmful to human health or welfare or the environment.

 - b. **Disclosure, Remediation, Liability, and Indemnification.** ROE expressly covenants and agrees that in the event any hazardous material is produced or stored at, brought to, or released on the leased premises, its agents, employees, invitees, clients, or licensees, or by the negligence of ROE, its agents, employees, invitees, clients, or licensees,
 - (i) ROE shall immediately notify COUNTY of the event;

 - (ii) ROE shall take immediate preventive measures to abate the presence of hazardous materials at the leased premises;

 - (iii) ROE shall remediate and clean up the leased premises to COUNTY's satisfaction;

Page six

- (iv) ROE shall be solely liable for all costs for removal of any hazardous material and for cleanup of the leased premises; and
 - (v) ROE shall be solely liable for damages arising from any such hazardous materials and does expressly indemnify and hold harmless COUNTY from any claims, liability, expenses or damages, fines, penalties or costs (including actual or incurred attorney's fees) therefor.
- c. **Survival.** ROE expressly covenants and agrees that the duties, obligations, and liabilities of ROE under the preceding section 14(a) and 14(b) shall survive the termination of this lease, and are binding upon ROE and its successors and assigns.
15. **Condemnation.** In the event a part of the leased premises shall be taken under the power of eminent domain by any legally constituted authority, and there remains a sufficient amount of space to permit ROE to carry on its business in a manner comparable to which it has become accustomed, then this lease shall continue, but the obligation to pay rent on the part of ROE shall be reduced in an amount proportionate to the area and relative value of the entire premises taken by such condemnation. In the event all of the leased premises shall be taken, or so much of the leased premises is taken that it is not feasible to continue a reasonably satisfactory operation of the business of ROE, then the lease shall be terminated. Such termination shall be without prejudice to the rights of either COUNTY or ROE to recover compensation from the condemning authority for any loss or damage caused by such condemnation. Neither COUNTY nor ROE shall have any right in or to any award made to the other by the condemning authority.
16. **Destruction.** Except as otherwise provided in this lease, in the event the leased premises are damaged by fire or other casualty covered by the insurance required herein, such damage shall be repaired with reasonable dispatch by and at the expense of COUNTY. Until such repairs are completed, the rent payable hereunder shall be abated in proportion to the area of the leased premises which is rendered untenable by ROE in the conduct of its business. In the event that such repairs cannot, in the reasonable opinion of the parties, be substantially completed within one hundred twenty (120) days after the occurrence of such damage, or if more than fifty percent (50%) of the leased premises have been rendered unoccupiable as a result of such damage, or if there has been a declaration of any governmental authority that the leased premises are unsafe or unfit for occupancy, then COUNTY or ROE shall have the right to terminate this lease, or any extensions thereof.
17. **Insolvency.** Neither this lease nor any interest therein, nor any estate thereby created, shall pass to any trustee or receiver or assignee for the benefit of creditors or otherwise by operation of law. In the event the estate created hereby shall be taken in execution or by other process of law, or if ROE shall be adjudicated insolvent pursuant to the provisions of any state or insolvency act, or if a receiver or trustee of the property of ROE shall be appointed by reason of ROE's insolvency or

Page seven

inability to pay its debts, or if any assignment shall be made of ROE's property for the benefit of creditors, then and in any such event, COUNTY, may at its option, terminate this lease, or any extensions thereof, and all rights of ROE hereunder, by giving ROE notice in writing of the election of COUNTY to so terminate.

18. **Assignment and Subletting.** ROE shall not assign or in any manner transfer this lease or any estate or interest herein without the express previous consent of COUNTY.

19. **Default.** If ROE shall fail to make any payment of any rent due hereunder within five (5) days of its due date, or if default shall continue in the performance of any of the other covenants or conditions which ROE is required to observe and perform under this lease for a period of thirty (30) days following written notice of such failure, or if ROE shall abandon or vacate the premises during the term of this lease, or if ROE shall cease to entirely own all business operations being carried on upon the premises, then COUNTY may, but need not, treat the occurrence of any one or more of the foregoing events as a breach of this lease, and thereupon may, at its option, without notice or demand of any kind to ROE have any one or more of the following described remedies in addition to all other rights and remedies provided at law or in equity:
 - a. Terminate this lease, or any extension thereof, repossess the leased premises, and be entitled to recover immediately, as liquidated agreed final damages, the total amount due to be paid by ROE during the balance of the term of this lease, or any extensions thereof, less the fair rental value of the premises for said period, together with any sum of money owed by ROE to COUNTY.

 - b. Without waiving its right to terminate this lease, or any extensions thereof, terminate ROE's right of possession and repossess the leased premises without demand or notice of any kind to ROE, in which case COUNTY may relet all or any part of the leased premises. ROE shall be responsible for all costs of reletting. ROE shall pay COUNTY on demand any deficiency from such reletting of COUNTY's inability to do so.

 - c. Have specific performance of ROE's obligations.

 - d. Cure the default and recover the cost of curing the same being on demand.

20. **Termination; Surrender of Possession.**
 - a. Upon the expiration or termination of this lease, or any extension thereof, ROE shall:

- (i) Restore the leased premises to their condition at the beginning of the term (other than as contemplated by paragraph (8) of this lease), ordinary wear and tear excepted, remove all of its personal property and trade fixtures from the leased premises and the property and repair any damage caused by such removal;
 - (ii) Surrender possession of the leased premises to COUNTY; and
 - (iii) Upon the request of COUNTY, at ROE's cost and expense, remove from the property all signs, symbols and trademarks pertaining to ROE's business and repair any damages caused by such removal; and
- b. If ROE shall fail or refuse to restore the leased premises as hereinabove provided, COUNTY may do so and recover its cost for so doing. COUNTY may, without notice, dispose of any property of ROE left upon the leased premises in any manner that COUNTY shall choose without incurring liability to ROE or to any other person. The failure of ROE to remove any property from the leased premises shall forever bar ROE from bringing any action or asserting any liability against COUNTY with respect to such property.

21. **Waiver.** One or more waivers of any covenant or condition by COUNTY shall not be construed as a waiver of a subsequent breach of the same covenant, and the consent or approval by COUNTY to or of any act of ROE requiring COUNTY's consent or approval shall not be deemed to waive or render unnecessary COUNTY's consent or approval to or of any subsequent act by ROE.

22. **Notices.** All notices, requests, demands and other communications required or permitted to be given hereunder shall be in writing and shall be deemed to have been given if delivered personally, or if sent by first-class mail, postage prepaid, return receipt requested to the following, or to such other address as shall be furnished in writing to one party by the other:

If to COUNTY:

Office of the County Administrator
McLean County
104 W. Front Street, Suite 701
P.O. Box 2400
Bloomington, Illinois 61702-2400

With Copies to:

Director, Facilities Management
McLean County
104 W. Front Street
P.O. Box 2400
Bloomington, Illinois 61702-2400

If to ROE:

Superintendent
Regional Office of Education for McLean/DeWitt/Livingston Counties
905 N. Main Street
Normal, Illinois 61761

23. **Agency.** Nothing contained herein shall be deemed or construed by the parties hereto, nor by any third party, as creating the relationship of principal and agent or partnership or of joint venture between the parties hereto, it being understood and agreed that neither the method of computation of rent, nor any other provision contained herein, nor any facts of the parties herein, shall be deemed to create any relationship between the parties hereto other than the relationship of landlord and tenant. Whenever herein the singular number is used, the same shall include the plural, and the masculine gender shall include the feminine and neuter genders.
24. **Partial Invalidity.** If any term or condition of this lease, or any extensions thereof, or the application thereof to any person or circumstance shall, to any extent, be invalid or unenforceable, the remainder of this lease, or any extension thereof, or the application of such term, covenant, or condition to persons or circumstances other than those as to which it is held invalid or unenforceable, shall not be affected thereby and each term, covenant, or condition of this lease shall be valid and be enforced to the fullest extent permitted by law.
25. **Holding Over.** Any holding over after the expiration of the term thereof with or without the consent of COUNTY, shall be construed to be a tenancy from month to month at the rents herein specified (prorated on a monthly basis) and shall otherwise be on the terms and conditions herein specified, so far as applicable.
26. **Successors.** All rights and liabilities herein given to, or imposed upon, the respective parties hereto shall extend to and bind the several respective heirs, executors, administrators, successors and assigns of the said parties; and if there shall be more than one tenant, they shall all be bound jointly and severally by the terms, covenants, and agreements herein. No rights, however, shall inure to the benefit of any assignee of ROE unless the assignment to such assignee has been approved by COUNTY in writing as provided herein.

Page ten

27. **Right to Terminate.** Notwithstanding any other provision of this lease to the contrary, either party shall have the right to terminate this lease during the initial term or any extension term by giving at least one hundred twenty (120) days prior written notice of termination to the other party, by abiding by paragraph 22, page eight (8) of this lease pertaining to all notices.
28. **Non-Affiliation Clause.** No member of the McLean County Board or any other COUNTY official shall have an interest in any contract let by the McLean County Board either as a contractor or subcontractor pursuant to Illinois Compiled Statutes, 50 ILCS 105/3, et seq.

IN WITNESS WHEREOF, the parties hereto have executed this agreement by their respective officers, there unto duly authorized at Bloomington, Illinois, this 21st day of October, 2003.

APPROVED:

**REGIONAL OFFICE OF EDUCATION
FOR McLEAN/DeWITT/LIVINGSTON
COUNTIES**

COUNTY OF McLEAN

By: _____

By: _____
Chairman, McLean County Board

ATTEST:

By: _____

By: _____
Clerk of the McLean County Board

ROE04.Doc

LEASE AGREEMENT

Between

The County of McLean

As Landlord

And

G.E.D. Adult Education Literacy Program

As Tenant,

For

Office Space Located in
905 N. Main Street, Normal, Illinois

Table of Contents

	<u>Page</u>
1. <u>Term.</u>	1
2. <u>Rent.</u>	1
3. <u>Tenant's Use and Operation.</u>	1
4. <u>Building Common Areas.</u>	1
5. <u>Maintenance and Repair.</u>	2
6. <u>Parking.</u>	2
7. <u>Alterations.</u>	2
8. <u>Insurance and Indemnity.</u>	2
9. <u>Conduct.</u>	4
10. <u>Signs.</u>	4
11. <u>Estoppel.</u>	4
12. <u>Access to Premises.</u>	4
13. <u>Hazardous Material.</u>	4
14. <u>Condemnation.</u>	5
15. <u>Destruction.</u>	6
16. <u>Insolvency.</u>	6
17. <u>Assignment and Subletting.</u>	6
18. <u>Default.</u>	6
19. <u>Termination; Surrender of Possession.</u>	7
20. <u>Waiver.</u>	8
21. <u>Notices.</u>	8

22. <u>Agency.</u>	8
23. <u>Partial Invalidity.</u>	8
24. <u>Holding Over.</u>	9
25. <u>Successors.</u>	9
26. <u>Right to Terminate.</u>	9
27. <u>Non-Affiliation Clause.</u>	9
Approval Signatures	9

Lease Agreement

WHEREAS, the County of McLean, a body corporate and politic, (hereinafter referred to as "COUNTY"), as landlord, and the G.E.D. Adult Education Literacy Program (hereinafter referred to as "GED"), as tenant, desire to continue a lease agreement for office space consisting of 3,905 s.f of office space located in the Fairview Building, 905 N. Main Street, Normal, Illinois, (hereinafter referred to as "BUILDING"); and,

WHEREAS, this lease agreement expressly sets forth the rights and duties of each party,

NOW THEREFORE, it is expressly agreed as follows:

1. **Term.** The term of the lease agreement shall commence on January 1, 2004, and terminate on December 31, 2004.

2. **Rent.**
 - a. GED shall be provided 3,905 s.f., or 36% (percent) of the 10,765 s.f. amount for an annual maintenance and operating expense of \$22,244.95. The McLean County Auditor's Office shall calculate and present to GED a monthly statement for the payment of this expense by GED representing GED's proportionate share of all utilities, (including electric, gas, water, and trash removal), maintenance, cleaning supplies, and maintenance equipment service contracts.

 - b. All rent payments shall be mailed to the below address:

**McLean County Treasurer
104 W. Front Street, Suite 706
Bloomington, Illinois 61702-2400**

 - c. The monthly rent payment during each month of the term of the lease shall be due and payable commencing on the first day of each month.

3. **Tenant's Use and Operation.** GED shall use the aforementioned leased premises only for the purposes of its general business office. GED shall not use the premises for any unlawful, improper, or immoral use, nor for any purpose or in any manner which is in violation of any present or future governmental law or regulation. GED shall, during the term of the lease agreement, continuously use the leased premises for the purposes stated herein.

4. **Building Common Areas.** GED shall be entitled to use of the areas designated from time to time by COUNTY as "common areas", and which are adjacent to or benefit the leased premises. Such common areas shall include adjoining sidewalks, entryway lobby, and lobby atrium areas for the purpose of egress and ingress of GED employees and clients. Such use shall be subject to the rules and regulations, as COUNTY shall from time to time issue.

5. **Maintenance and Repair.** COUNTY shall be responsible for compliance with all building codes, the American's with Disabilities Act (as to permanent improvements only) and any other environmental or building safety issues and any state, local, and federal regulations relating thereto, perform all general building maintenance and repair. Notwithstanding the foregoing, COUNTY shall not be responsible for the cost of repairs and maintenance caused by intentional acts or negligence of GED employees, agents, or clients. GED shall keep the interior of premises as well as any portion of the leased premises visible from the exterior clear, orderly, and in good condition and repair, at its own expense. GED shall keep all glass areas of leased premises clean which are visible from the BUILDING common area hallways. GED shall be responsible for their own custodial needs, equipment, and supplies and the replacement cost of ceiling mounted light fixture lamps.
6. **Parking.** GED is permitted use of the adjacent parking lot of BUILDING for its employees and clients, on a first-come, first-served basis. Parking stalls shall not be assigned. Furthermore, GED agrees and understands that other tenants and COUNTY offices also use said parking located at BUILDING, and that GED agrees not to park in the parking lot of the nearby McLean County Nursing Home nor the McLean County Juvenile Detention Center.
7. **Alterations.** No alterations, additions, or improvements shall be made in or to the leased premises by GED without the prior express written approval of COUNTY. All alterations, additions, improvements, and fixtures which may be made or installed by either of the parties hereto upon the leased premises and which in any manner are attached to the floors, walls, or ceiling, with the exception of GED displays and trade fixtures, shall be the property of COUNTY and at the termination of this lease shall remain upon and be surrendered with the leased premises as a part thereof, without disturbance, molestation or injury. Notwithstanding the foregoing, COUNTY may designate by written notice to GED certain fixtures, trade fixtures, alterations and additions to the leased premises which shall be removed by GED at the expiration of this lease agreement. The parties hereto may also agree in writing, prior to the installation or construction of any alterations, improvements, or fixtures to the leased premises by GED that GED may either cause the removal of such items at the time of expiration of this lease, or that they may be left in the leased premises. GED shall, at its own expense, repair any damages to the leased premises caused by the removal of its fixtures or alterations.
8. **Insurance and Indemnity.**
 - a. **Covenants to Hold Harmless.** GED agrees to save and hold harmless COUNTY (including its officials, agents, and employees) free and harmless from all liability, public or private, penalties, contractual or otherwise, losses, damages, costs, attorney's fees, court costs, expenses, causes of action, claims or judgements, resulting from claimed natural persons and any other legal entity, or

property of any kind (including, but not limited to choses in action) arising out of or in any way connected with this undertaking, whether or not arising out of the partial or sole negligence of COUNTY or its officials, agents, or employees, and shall indemnify COUNTY from any costs, expenses, judgements, and attorney's fees paid or incurred by or on behalf of COUNTY and/or its agents and employees.

- b. **Fire and Casualty Insurance.** COUNTY shall be responsible for obtaining and maintaining a policy of fire and casualty insurance with extended coverage provisions applicable to the leased premises and protecting COUNTY against loss due to the structure of the premises. GED shall be responsible for obtaining and maintaining a policy for fire and casualty insurance protecting GED against loss or damage to its furnishings, equipment, and personal property in or on the leased premises.
- c. **Added Risk.** GED shall also pay any increase in the fire and casualty insurance rates or premiums on the leased premises caused by any increased risk or hazardous business carried on by GED in the leased premises. The determination of the insurance carrier shall be binding upon the parties as to the added risk resulting from GED business. GED's share of the annual insurance premiums for such insurance, as required by this paragraph, shall be paid within ten (10) days after GED is given written request for same. COUNTY shall bill GED without notice or negotiation for any rate increase.
- d. **Obligation to Carry Public Liability Insurance.** GED shall, during the entire term hereof, keep in full force a policy of public liability insurance with respect to the leased premises and the business operated by GED in the leased premises, and in which the limits of liability shall not be less than One Million Dollars (\$1,000,000.00), for personal injuries to any person or persons arising out of a single accident and Five Hundred Thousand Dollars (\$500,000.00) for property damage resulting from any one occurrence. COUNTY shall be named as an additional insured in all policies of liability insurance maintained pursuant to this provision. GED shall furnish COUNTY a Certificate of Insurance of evidence of insurance that such insurance is in force at all times during the term of the lease. GED shall furnish COUNTY additional certificates of GED's insurance within twenty (20) days of receipt of a written request from COUNTY for such certificate.

Insurance shall be in a form acceptable to COUNTY and written by an insurance company admitted in the state of Illinois for such coverage.

- e. **Waiver of Subrogation Rights Under Insurance Policies.** Notwithstanding anything to the contrary contained herein, each of the parties hereto releases the other, and other tenants in BUILDING, to the extent of each party's insurance coverage, from any liability for any loss or damage which may be inflicted upon the property of such party even if such loss or damage shall be brought about by the fault or negligence of the other party, or other tenants, or their agents, employees or assigns; provided, however, that this release shall be effective only with respect to loss or damage occurring during such time as the appropriate policy of insurance contains a clause to the effect that this release shall not affect the policy or the right of the insured to recover thereunder.
9. **Conduct.** GED shall not cause or permit any conduct to take place within the leased premises which in any way disturbs or annoys other tenants or occupants of BUILDING, or adjacent buildings.
10. **Signs.** No sign, banner, decoration, picture, advertisement, awning, merchandise, or notice on the outside of leased premises or BUILDING, or which can be seen from the outside of leased premises, shall be installed or maintained by GED without the prior express written approval of COUNTY.
11. **Estoppel.** Each party, within ten (10) days after notice from the other party, shall execute to the other party, in recordable form, a certificate stating that this lease is unmodified and in full force and effect, or in full force and effect as modified, and stating the modifications. The certificate shall also state the number of the base rental, the date to which the rent has been paid in advance, and the amount of any security deposit or prepaid rent. Failure to deliver the certificate within the ten (10) days shall be conclusive upon the party failing to so deliver for the benefit of the party requesting the certificate and any successor to the party so requesting, that this lease is in full force and effect and has not been modified except as may be represented by the party requesting the certificate.
12. **Access to the Premises.** COUNTY shall have the right to enter upon the leased premises at anytime for the purpose of inspecting the same, or of making repairs, or alternations to the leased premises or any property owned or controlled by COUNTY. For a period commencing one hundred twenty (120) days prior to the termination of this lease, COUNTY may have reasonable access to the leased premises for the purpose of exhibiting the same to prospective tenants.
13. **Hazardous Material.**
 - a. **Prohibition.** GED expressly covenants and agrees that it will not cause or permit to be brought to, produced upon, disposed of or stored at the leased premises an hazardous material. For purposes of this provision, hazardous material shall mean any substance, in any form which is regulated or prohibited

by statute, regulation, ordinance or rule including, but not limited to the Comprehensive Environmental Response, Comprehensive and Liability Act, 42 USC 6901, et seq. and regulations promulgated thereunder; the Toxic Substances Control Act, 15 USC 2601, et seq. and regulations promulgated thereunder; of the state of Illinois statutes; or any substance which may be harmful to human health or welfare or the environment.

b. **Disclosure, Remediation, Liability, and Indemnification.** GED expressly covenants and agrees that in the event any hazardous material is produced or stored at, brought to, or released on the leased premises, its agents, employees, invitees, clients, or licensees, or by the negligence of GED, its agents, employees, invitees, clients, or licensees,

- (i) GED shall immediately notify COUNTY of the event;
- (ii) GED shall take immediate preventive measures to abate the presence of hazardous materials at the leased premises;
- (iii) GED shall remediate and clean up the leased premises to COUNTY's satisfaction;
- (iv) GED shall be solely liable for all costs for removal of any hazardous material and for cleanup of the leased premises; and
- (v) GED shall be solely liable for damages arising from any such hazardous materials and does expressly indemnify and hold harmless COUNTY from any claims, liability, expenses or damages, fines, penalties or costs (including actual or incurred attorney's fees) therefor.

c. **Survival.** GED expressly covenants and agrees that the duties, obligations, and liabilities of GED under the preceding section 14(a) and 14(b) shall survive the termination of this lease, and are binding upon GED and its successors and assigns.

14. **Condemnation.** In the event a part of the leased premises shall be taken under the power of eminent domain by any legally constituted authority, and there remains a sufficient amount of space to permit GED to carry on its business in a manner comparable to which it has become accustomed, then this lease shall continue, but the obligation to pay rent on the part of GED shall be reduced in an amount proportionate to the area and relative value of the entire premises taken by such condemnation. In the event all of the leased premises shall be taken, or so much of the leased premises is taken that it is not feasible to continue a reasonably satisfactory operation of the business of GED, then the lease shall be terminated. Such termination shall be without prejudice to the rights of either COUNTY or GED to recover compensation from the condemning authority for any loss or

damage caused by such condemnation. Neither COUNTY nor GED shall have any right in or to any award made to the other by the condemning authority.

15. **Destruction.** Except as otherwise provided in this lease, in the event the leased premises are damaged by fire or other casualty covered by the insurance required herein, such damage shall be repaired with reasonable dispatch by and at the expense of COUNTY. Until such repairs are completed, the rent payable hereunder shall be abated in proportion to the area of the leased premises which is rendered untenable by GED in the conduct of its business. In the event that such repairs cannot, in the reasonable opinion of the parties, be substantially completed within one hundred twenty (120) days after the occurrence of such damage, or if more than fifty percent (50%) of the leased premises have been rendered unoccupiable as a result of such damage, or if there has been a declaration of any governmental authority that the leased premises are unsafe or unfit for occupancy, then COUNTY or GED shall have the right to terminate this lease, or any extensions thereof.
16. **Insolvency.** Neither this lease nor any interest therein, nor any estate thereby created, shall pass to any trustee or receiver or assignee for the benefit of creditors or otherwise by operation of law. In the event the estate created hereby shall be taken in execution or by other process of law, or if GED shall be adjudicated insolvent pursuant to the provisions of any state or insolvency act, or if a receiver or trustee of the property of GED shall be appointed by reason of GED's insolvency or inability to pay its debts, or if any assignment shall be made of GED's property for the benefit of creditors, then and in any such event, COUNTY, may at its option, terminate this lease, or any extensions thereof, and all rights of GED hereunder, by giving GED notice in writing of the election of COUNTY to so terminate.
17. **Assignment and Subletting.** GED shall not assign or in any manner transfer this lease or any estate or interest herein without the express previous consent of COUNTY.
18. **Default.** If GED shall fail to make any payment of any rent due hereunder within five (5) days of its due date, or if default shall continue in the performance of any of the other covenants or conditions which GED is required to observe and perform under this lease for a period of thirty (30) days following written notice of such failure, or if GED shall abandon or vacate the premises during the term of this lease, or if GED shall cease to entirely own all business operations being carried on upon the premises, then COUNTY may, but need not, treat the occurrence of any one or more of the foregoing events as a breach of this lease, and thereupon may, at its option, without notice or demand of any kind to GED have any one or more of the following described remedies in addition to all other rights and remedies provided at law or in equity:

- a. Terminate this lease, or any extension thereof, repossess the leased premises, and be entitled to recover immediately, as liquidated agreed final damages, the total amount due to be paid by GED during the balance of the term of this lease, or any extensions thereof, less the fair rental value of the premises for said period, together with any sum of money owed by GED to COUNTY.
- b. Without waiving its right to terminate this lease, or any extensions thereof, terminate GED's right of possession and repossess the leased premises without demand or notice of any kind to GED, in which case COUNTY may relet all or any part of the leased premises. GED shall be responsible for all costs of reletting. GED shall pay COUNTY on demand any deficiency from such reletting of COUNTY's inability to do so.
- c. Have specific performance of GED's obligations.
- d. Cure the default and recover the cost of curing the same being on demand.

19. Termination; Surrender of Possession.

- a. Upon the expiration or termination of this lease, or any extension thereof, GED shall:
 - (i) Restore the leased premises to their condition at the beginning of the term (other than as contemplated by paragraph (8) of this lease), ordinary wear and tear excepted, remove all of its personal property and trade fixtures from the leased premises and the property and repair any damage caused by such removal;
 - (ii) Surrender possession of the leased premises to COUNTY; and
 - (iii) Upon the request of COUNTY, at GED's cost and expense, remove from the property all signs, symbols and trademarks pertaining to GED's business and repair any damages caused by such removal; and
- b. If GED shall fail or refuse to restore the leased premises as hereinabove provided, COUNTY may do so and recover its cost for so doing. COUNTY may, without notice, dispose of any property of GED left upon the leased premises in any manner that COUNTY shall choose without incurring liability to GED or to any other person. The failure of GED to remove any property from the leased premises shall forever bar GED from bringing any action or asserting any liability against COUNTY with respect to such property.

Page eight

20. **Waiver.** One or more waivers of any covenant or condition by COUNTY shall not be construed as a waiver of a subsequent breach of the same covenant, and the consent or approval by COUNTY to or of any act of GED requiring COUNTY's consent or approval shall not be deemed to waive or render unnecessary COUNTY's consent or approval to or of any subsequent act by GED.
21. **Notices.** All notices, requests, demands and other communications required or permitted to be given hereunder shall be in writing and shall be deemed to have been given if delivered personally, or if sent by first-class mail, postage prepaid, return receipt requested to the following, or to such other address as shall be furnished in writing to one party by the other:

If to COUNTY:

Office of the County Administrator
McLean County
104 W. Front Street, Suite 701
P.O. Box 2400
Bloomington, Illinois 61702-2400

With Copies to:

Director, Facilities Management
McLean County
104 W. Front Street
P.O. Box 2400
Bloomington, Illinois 61702-2400

If to GED:

Superintendent
G.E.D. Adult Literacy Program
905 N. Main Street
Normal, Illinois 61761

22. **Agency.** Nothing contained herein shall be deemed or construed by the parties hereto, nor by any third party, as creating the relationship of principal and agent or partnership or of joint venture between the parties hereto, it being understood and agreed that neither the method of computation of rent, nor any other provision contained herein, nor any facts of the parties herein, shall be deemed to create any relationship between the parties hereto other than the relationship of landlord and tenant. Whenever herein the singular number is used, the same shall include the plural, and the masculine gender shall include the feminine and neuter genders.
23. **Partial Invalidity.** If any term or condition of this lease, or any extensions thereof, or the application thereof to any person or circumstance shall, to any extent, be invalid or unenforceable, the remainder of this lease, or any extension thereof, or the

application of such term, covenant, or condition to persons or circumstances other than those as to which it is held invalid or unenforceable, shall not be affected thereby and each term, covenant, or condition of this lease shall be valid and be enforced to the fullest extent permitted by law.

- 24. **Holding Over.** Any holding over after the expiration of the term thereof with or without the consent of COUNTY, shall be construed to be a tenancy from month to month at the rents herein specified (prorated on a monthly basis) and shall otherwise be on the terms and conditions herein specified, so far as applicable.
- 25. **Successors.** All rights and liabilities herein given to, or imposed upon, the respective parties hereto shall extend to and bind the several respective heirs, executors, administrators, successors and assigns of the said parties; and if there shall be more than one tenant, they shall all be bound jointly and severally by the terms, covenants, and agreements herein. No rights, however, shall inure to the benefit of any assignee of GED unless the assignment to such assignee has been approved by COUNTY in writing as provided herein.
- 26. **Right to Terminate.** Notwithstanding any other provision of this lease to the contrary, either party shall have the right to terminate this lease during the initial term or any extension term by giving at least one hundred twenty (120) days prior written notice of termination to the other party, by abiding by paragraph 22, page eight (8) of this lease pertaining to all notices.
- 27. **Non-Affiliation Clause.** No member of the McLean County Board or any other COUNTY official shall have an interest in any contract let by the McLean County Board either as a contractor or subcontractor pursuant to Illinois Compiled Statutes, 50 ILCS 105/3, et seq.

IN WITNESS WHEREOF, the parties hereto have executed this agreement by their respective officers, there unto duly authorized at Bloomington, Illinois, this 21st day of October, 2003.

APPROVED:

**G.E.D. ADULT EDUCATION
LITERACY PROGRAM**

By: _____

ATTEST:

By: _____

COUNTY OF McLEAN

By: _____
Chairman, McLean County Board

By: _____
Clerk of the McLean County Board

LEASE AGREEMENT

Between

The County of McLean

As Landlord

And

YWCA OF McLEAN COUNTY

As Tenant,

For

Office Space Located on the First Floor of
905 N. Main Street, Normal, Illinois

Table of Contents

	<u>Page</u>
1. <u>Term.</u>	1
2. <u>Rent.</u>	1
3. <u>Capital Improvement Fund.</u>	1
4. <u>Tenant's Use and Operation.</u>	2
5. <u>Building Common Areas.</u>	2
6. <u>Maintenance and Repair.</u>	2
7. <u>Parking.</u>	2
8. <u>Alterations.</u>	3
9. <u>Insurance and Indemnity.</u>	3
10. <u>Conduct.</u>	4
11. <u>Signs.</u>	4
12. <u>Estoppel.</u>	4
13. <u>Access to Premises.</u>	5
14. <u>Hazardous Material.</u>	5
15. <u>Condemnation.</u>	6
16. <u>Destruction.</u>	6
17. <u>Insolvency.</u>	6
18. <u>Assignment and Subletting.</u>	7
19. <u>Default.</u>	7
20. <u>Termination; Surrender of Possession.</u>	7
21. <u>Waiver.</u>	8

22. <u>Notices.</u>	8
23. <u>Agency.</u>	9
24. <u>Partial Invalidity.</u>	9
25. <u>Holding Over.</u>	9
26. <u>Successors.</u>	9
27. <u>Right to Terminate.</u>	10
28. <u>Non-Affiliation Clause.</u>	10
Approval Signatures	10

Lease Agreement

WHEREAS, the County of McLean, a body corporate and politic, (hereinafter referred to as "COUNTY"), as landlord, and YWCA of McLean County, (hereinafter referred to as "YWCA"), as tenant, desire to continue a lease agreement for office space consisting of 1,198 s.f. located on the first floor of the Fairview Building, 905 N. Main Street, Normal, Illinois, (hereinafter referred to as 'BUILDING'); and,

WHEREAS, this lease agreement expressly sets forth the rights and duties of each party,

NOW THEREFORE, it is expressly agreed as follows:

1. **Term.** The term of the lease agreement shall commence on January 1, 2004, and terminate on December 31, 2004.
2. **Rent.**
 - a. YWCA agrees to pay COUNTY \$7,663.88 for the term of this lease agreement, payable in twelve equal monthly installments of \$638.66 representing the YWCA's proportionate share of all utilities, (including electric, gas, water, and trash removal), maintenance, cleaning supplies, and maintenance equipment service contracts. Furthermore, the YWCA agrees to pay COUNTY a monthly rental payment of \$262.07 which includes \$50.00 per month to the Capital Improvement Replacement Fund for BUILDING.
 - b. All rent payments shall be mailed to the below address:

**McLean County Treasurer
104 W. Front Street, Suite 706
Bloomington, Illinois 61702-2400**
 - c. The monthly rent payment during each month of the term of the lease shall be due and payable commencing on the first day of each month.
3. **Capital Improvement Fund.** All monies paid into this FUND by YWCA shall be reserved by COUNTY to pay for major capital improvement replacement expenses for BUILDING. A major capital improvement replacement expense shall be defined as follows:
 - a. Additions and/or renovations to BUILDING and the adjacent property;
 - b. Capital equipment purchases for mechanical, electrical, and HVAC equipment servicing BUILDING;
 - b. Capital equipment and fixtures purchases for BUILDING with a depreciated life expectancy greater than seven (7) years.

In the event COUNTY determines that a major capital improvement replacement expense is necessary and the capital improvement replacement fund is not sufficient to fully fund 100% of the expense, COUNTY agrees to pay for the major capital improvement replacement expense from other COUNTY sources. COUNTY and YWCA agree that COUNTY shall then be reimbursed for this expense over time from the funds on deposit in the capital improvement replacement fund.

4. **Tenant's Use and Operation.** YWCA shall use the aforementioned leased premises only for the purposes of its general business office. YWCA shall not use the premises for any unlawful, improper, or immoral use, nor for any purpose or in any manner which is in violation of any present or future governmental law or regulation. YWCA shall, during the term of the lease agreement, continuously use the leased premises for the purposes stated herein.
5. **Building Common Areas.** YWCA shall be entitled to use of the areas designated from time to time by COUNTY as "common areas", and which are adjacent to or benefit the leased premises. Such common areas shall include adjoining sidewalks, entryway lobby, and lobby atrium areas for the purpose of egress and ingress of YWCA employees and clients. Such use shall be subject to the rules and regulations, as COUNTY shall from time to time issue.
6. **Maintenance and Repair.** COUNTY shall be responsible for compliance with all building codes, the American's with Disabilities Act (as to permanent improvements only) and any other environmental or building safety issues and any state, local, and federal regulations relating thereto, perform all general building maintenance and repair. Notwithstanding the foregoing, COUNTY shall not be responsible for the cost of repairs and maintenance caused by intentional acts or negligence of YWCA employees, agents, or clients. YWCA shall keep the interior of premises as well as any portion of the leased premises visible from the exterior clear, orderly, and in good condition and repair, at its own expense. YWCA shall keep all glass areas of leased premises clean which are visible from the BUILDING common area hallways. YWCA shall be responsible for their own custodial needs, equipment, and supplies and the replacement cost of ceiling mounted light fixture lamps.
7. **Parking.** YWCA is permitted use of the adjacent parking lot of BUILDING for its employees and clients, on a first-come, first-served basis. Parking stalls shall not be assigned. Furthermore, YWCA agrees and understands that other tenants and COUNTY offices also use said parking located at BUILDING, and that YWCA agrees not to park in the parking lot of the nearby McLean County Nursing Home nor the McLean County Juvenile Detention Center.

8. **Alterations.** No alterations, additions, or improvements shall be made in or to the leased premises by YWCA without the prior express written approval of COUNTY. All alterations, additions, improvements, and fixtures which may be made or installed by either of the parties hereto upon the leased premises and which in any manner are attached to the floors, walls, or ceiling, with the exception of YWCA displays and trade fixtures, shall be the property of COUNTY and at the termination of this lease shall remain upon and be surrendered with the leased premises as a part thereof, without disturbance, molestation or injury. Notwithstanding the foregoing, COUNTY may designate by written notice to YWCA certain fixtures, trade fixtures, alterations and additions to the leased premises which shall be removed by YWCA at the expiration of this lease agreement. The parties hereto may also agree in writing, prior to the installation or construction of any alterations, improvements, or fixtures to the leased premises by YWCA that YWCA may either cause the removal of such items at the time of expiration of this lease, or that they may be left in the leased premises. YWCA shall, at its own expense, repair any damages to the leased premises caused by the removal of its fixtures or alterations.

9. **Insurance and Indemnity.**
 - a. **Covenants to Hold Harmless.** YWCA agrees to save and hold harmless COUNTY (including its officials, agents, and employees) free and harmless from all liability, public or private, penalties, contractual or otherwise, losses, damages, costs, attorney's fees, court costs, expenses, causes of action, claims or judgements, resulting from claimed natural persons and any other legal entity, or property of any kind (including, but not limited to choses in action) arising out of or in any way connected with this undertaking, whether or not arising out of the partial or sole negligence of COUNTY or its officials, agents, or employees, and shall indemnify COUNTY from any costs, expenses, judgements, and attorney's fees paid or incurred by or on behalf of COUNTY and/or its agents and employees.

 - b. **Fire and Casualty Insurance.** COUNTY shall be responsible for obtaining and maintaining a policy of fire and casualty insurance with extended coverage provisions applicable to the leased premises and protecting COUNTY against loss due to the structure of the premises. YWCA shall be responsible for obtaining and maintaining a policy for fire and casualty insurance protecting YWCA against loss or damage to its furnishings, equipment, and personal property in or on the leased premises.

 - c. **Added Risk.** YWCA shall also pay any increase in the fire and casualty insurance rates or premiums on the leased premises caused by any increased risk or hazardous business carried on by YWCA in the leased premises. The determination of the insurance carrier shall be binding upon the parties as to the added risk resulting from YWCA business. YWCA's share of the annual

insurance premiums for such insurance, as required by this paragraph, shall be paid within ten (10) days after YWCA is given written request for same. COUNTY shall bill YWCA without notice or negotiation for any rate increase.

- d. **Obligation to Carry Public Liability Insurance.** YWCA shall, during the entire term hereof, keep in full force a policy of public liability insurance with respect to the leased premises and the business operated by YWCA in the leased premises, and in which the limits of liability shall not be less than One Million Dollars (\$1,000,000.00), for personal injuries to any person or persons arising out of a single accident and Five Hundred Thousand Dollars (\$500,000.00) for property damage resulting from any one occurrence. COUNTY shall be named as an additional insured in all policies of liability insurance maintained pursuant to this provision. YWCA shall furnish COUNTY a Certificate of Insurance of evidence of insurance that such insurance is in force at all times during the term of the lease. YWCA shall furnish COUNTY additional certificates of YWCA's insurance within twenty (20) days of receipt of a written request from COUNTY for such certificate.

Insurance shall be in a form acceptable to COUNTY and written by an insurance company admitted in the state of Illinois for such coverage.

- e. **Waiver of Subrogation Rights Under Insurance Policies.** Notwithstanding anything to the contrary contained herein, each of the parties hereto releases the other, and other tenants in BUILDING, to the extent of each party's insurance coverage, from any liability for any loss or damage which may be inflicted upon the property of such party even if such loss or damage shall be brought about by the fault or negligence of the other party, or other tenants, or their agents, employees or assigns; provided, however, that this release shall be effective only with respect to loss or damage occurring during such time as the appropriate policy of insurance contains a clause to the effect that this release shall not affect the policy or the right of the insured to recover thereunder.
10. **Conduct.** YWCA shall not cause or permit any conduct to take place within the leased premises which in any way disturbs or annoys other tenants or occupants of BUILDING, or adjacent buildings.
11. **Signs.** No sign, banner, decoration, picture, advertisement, awning, merchandise, or notice on the outside of leased premises or BUILDING, or which can be seen from the outside of leased premises, shall be installed or maintained by YWCA without the prior express written approval of COUNTY.
12. **Estoppel.** Each party, within ten (10) days after notice from the other party, shall execute to the other party, in recordable form, a certificate stating that this lease is unmodified and in full force and effect, or in full force and effect as modified, and

stating the modifications. The certificate shall also state the number of the base rental, the date to which the rent has been paid in advance, and the amount of any security deposit or prepaid rent. Failure to deliver the certificate within the ten (10) days shall be conclusive upon the party failing to so deliver for the benefit of the party requesting the certificate and any successor to the party so requesting, that this lease is in full force and effect and has not been modified except as may be represented by the party requesting the certificate.

13. **Access to the Premises.** COUNTY shall have the right to enter upon the leased premises at anytime for the purpose of inspecting the same, or of making repairs, or alternations to the leased premises or any property owned or controlled by COUNTY. For a period commencing one hundred twenty (120) days prior to the termination of this lease, COUNTY may have reasonable access to the leased premises for the purpose of exhibiting the same to prospective tenants.

14. **Hazardous Material.**

a. **Prohibition.** YWCA expressly covenants and agrees that it will not cause or permit to be brought to, produced upon, disposed of or stored at the leased premises an hazardous material. For purposes of this provision, hazardous material shall mean any substance, in any form which is regulated or prohibited by statute, regulation, ordinance or rule including, but not limited to the Comprehensive Environmental Response, Comprehensive and Liability Act, 42 USC 6901, et seq. and regulations promulgated thereunder; the Toxic Substances Control Act, 15 USC 2601, et seq. and regulations promulgated thereunder; of the state of Illinois statutes; or any substance which may be harmful to human health or welfare or the environment.

b. **Disclosure, Remediation, Liability, and Indemnification.** YWCA expressly covenants and agrees that in the event any hazardous material is produced or stored at, brought to, or released on the leased premises, its agents, employees, invitees, clients, or licensees, or by the negligence of YWCA, its agents, employees, invitees, clients, or licensees,

- (i) YWCA shall immediately notify COUNTY of the event;
- (ii) YWCA shall take immediate preventive measures to abate the presence of hazardous materials at the leased premises;
- (iii) YWCA shall remediate and clean up the leased premises to COUNTY's satisfaction;
- (iv) YWCA shall be solely liable for all costs for removal of any hazardous material and for cleanup of the leased premises; and

- (v) YWCA shall be solely liable for damages arising from any such hazardous materials and does expressly indemnify and hold harmless COUNTY from any claims, liability, expenses or damages, fines, penalties or costs (including actual or incurred attorney's fees) therefor.
 - c. **Survival.** YWCA expressly covenants and agrees that the duties, obligations, and liabilities of YWCA under the preceding section 14(a) and 14(b) shall survive the termination of this lease, and are binding upon YWCA and its successors and assigns.
15. **Condemnation.** In the event a part of the leased premises shall be taken under the power of eminent domain by any legally constituted authority, and there remains a sufficient amount of space to permit YWCA to carry on its business in a manner comparable to which it has become accustomed, then this lease shall continue, but the obligation to pay rent on the part of YWCA shall be reduced in an amount proportionate to the area and relative value of the entire premises taken by such condemnation. In the event all of the leased premises shall be taken, or so much of the leased premises is taken that it is not feasible to continue a reasonably satisfactory operation of the business of YWCA, then the lease shall be terminated. Such termination shall be without prejudice to the rights of either COUNTY or YWCA to recover compensation from the condemning authority for any loss or damage caused by such condemnation. Neither COUNTY nor YWCA shall have any right in or to any award made to the other by the condemning authority.
16. **Destruction.** Except as otherwise provided in this lease, in the event the leased premises are damaged by fire or other casualty covered by the insurance required herein, such damage shall be repaired with reasonable dispatch by and at the expense of COUNTY. Until such repairs are completed, the rent payable hereunder shall be abated in proportion to the area of the leased premises which is rendered untenable by YWCA in the conduct of its business. In the event that such repairs cannot, in the reasonable opinion of the parties, be substantially completed within one hundred twenty (120) days after the occurrence of such damage, or if more than fifty percent (50%) of the leased premises have been rendered unoccupiable as a result of such damage, or if there has been a declaration of any governmental authority that the leased premises are unsafe or unfit for occupancy, then COUNTY or YWCA shall have the right to terminate this lease, or any extensions thereof.
17. **Insolvency.** Neither this lease nor any interest therein, nor any estate thereby created, shall pass to any trustee or receiver or assignee for the benefit of creditors or otherwise by operation of law. In the event the estate created hereby shall be taken in execution or by other process of law, or if YWCA shall be adjudicated insolvent pursuant to the provisions of any state or insolvency act, or if a receiver or trustee of the property of YWCA shall be appointed by reason of YWCA's insolvency or

Page seven

inability to pay its debts, or if any assignment shall be made of YWCA's property for the benefit of creditors, then and in any such event, COUNTY, may at its option, terminate this lease, or any extensions thereof, and all rights of YWCA hereunder, by giving YWCA notice in writing of the election of COUNTY to so terminate.

18. **Assignment and Subletting.** YWCA shall not assign or in any manner transfer this lease or any estate or interest herein without the express previous consent of COUNTY.

19. **Default.** If YWCA shall fail to make any payment of any rent due hereunder within five (5) days of its due date, or if default shall continue in the performance of any of the other covenants or conditions which YWCA is required to observe and perform under this lease for a period of thirty (30) days following written notice of such failure, or if YWCA shall abandon or vacate the premises during the term of this lease, or if YWCA shall cease to entirely own all business operations being carried on upon the premises, then COUNTY may, but need not, treat the occurrence of any one or more of the foregoing events as a breach of this lease, and thereupon may, at its option, without notice or demand of any kind to YWCA have any one or more of the following described remedies in addition to all other rights and remedies provided at law or in equity:

- a. Terminate this lease, or any extension thereof, repossess the leased premises, and be entitled to recover immediately, as liquidated agreed final damages, the total amount due to be paid by YWCA during the balance of the term of this lease, or any extensions thereof, less the fair rental value of the premises for said period, together with any sum of money owed by YWCA to COUNTY.
- b. Without waiving its right to terminate this lease, or any extensions thereof, terminate YWCA's right of possession and repossess the leased premises without demand or notice of any kind to YWCA, in which case COUNTY may relet all or any part of the leased premises. YWCA shall be responsible for all costs of reletting. YWCA shall pay COUNTY on demand any deficiency from such reletting of COUNTY's inability to do so.
- c. Have specific performance of YWCA's obligations.
- d. Cure the default and recover the cost of curing the same being on demand.

20. **Termination; Surrender of Possession.**

- a. Upon the expiration or termination of this lease, or any extension thereof, YWCA shall:

- (i) Restore the leased premises to their condition at the beginning of the term (other than as contemplated by paragraph (8) of this lease), ordinary wear and tear excepted, remove all of its personal property and trade fixtures from the leased premises and the property and repair any damage caused by such removal;
- (ii) Surrender possession of the leased premises to COUNTY; and
- (iii) Upon the request of COUNTY, at YWCA's cost and expense, remove from the property all signs, symbols and trademarks pertaining to YWCA's business and repair any damages caused by such removal; and

b. If YWCA shall fail or refuse to restore the leased premises as hereinabove provided, COUNTY may do so and recover its cost for so doing. COUNTY may, without notice, dispose of any property of YWCA left upon the leased premises in any manner that COUNTY shall choose without incurring liability to YWCA or to any other person. The failure of YWCA to remove any property from the leased premises shall forever bar YWCA from bringing any action or asserting any liability against COUNTY with respect to such property.

21. **Waiver.** One or more waivers of any covenant or condition by COUNTY shall not be construed as a waiver of a subsequent breach of the same covenant, and the consent or approval by COUNTY to or of any act of YWCA requiring COUNTY's consent or approval shall not be deemed to waive or render unnecessary COUNTY's consent or approval to or of any subsequent act by YWCA.

22. **Notices.** All notices, requests, demands and other communications required or permitted to be given hereunder shall be in writing and shall be deemed to have been given if delivered personally, or if sent by first-class mail, postage prepaid, return receipt requested to the following, or to such other address as shall be furnished in writing to one party by the other:

If to COUNTY:

Office of the County Administrator
McLean County
104 W. Front Street, Suite 701
P.O. Box 2400
Bloomington, Illinois 61702-2400

Page nine

With Copies to:

Director, Facilities Management
McLean County
104 W. Front Street
P.O. Box 2400
Bloomington, Illinois 61702-2400

If to YWCA:

Executive Director
YWCA of McLean County
905 N. Main Street, 1st Floor
Normal, Illinois 61761

23. **Agency.** Nothing contained herein shall be deemed or construed by the parties hereto, nor by any third party, as creating the relationship of principal and agent or partnership or of joint venture between the parties hereto, it being understood and agreed that neither the method of computation of rent, nor any other provision contained herein, nor any facts of the parties herein, shall be deemed to create any relationship between the parties hereto other than the relationship of landlord and tenant. Whenever herein the singular number is used, the same shall include the plural, and the masculine gender shall include the feminine and neuter genders.
24. **Partial Invalidity.** If any term or condition of this lease, or any extensions thereof, or the application thereof to any person or circumstance shall, to any extent, be invalid or unenforceable, the remainder of this lease, or any extension thereof, or the application of such term, covenant, or condition to persons or circumstances other than those as to which it is held invalid or unenforceable, shall not be affected thereby and each term, covenant, or condition of this lease shall be valid and be enforced to the fullest extent permitted by law.
25. **Holding Over.** Any holding over after the expiration of the term thereof with or without the consent of COUNTY, shall be construed to be a tenancy from month to month at the rents herein specified (prorated on a monthly basis) and shall otherwise be on the terms and conditions herein specified, so far as applicable.
26. **Successors.** All rights and liabilities herein given to, or imposed upon, the respective parties hereto shall extend to and bind the several respective heirs, executors, administrators, successors and assigns of the said parties; and if there shall be more than one tenant, they shall all be bound jointly and severally by the terms, covenants, and agreements herein. No rights, however, shall inure to the benefit of any assignee of YWCA unless the assignment to such assignee has been approved by COUNTY in writing as provided herein.

Page ten

27. **Right to Terminate.** Notwithstanding any other provision of this lease to the contrary, either party shall have the right to terminate this lease during the initial term or any extension term by giving at least one hundred twenty (120) days prior written notice of termination to the other party, by abiding by paragraph 22, page eight (8) of this lease pertaining to all notices.
28. **Non-Affiliation Clause.** No member of the McLean County Board or any other COUNTY official shall have an interest in any contract let by the McLean County Board either as a contractor or subcontractor pursuant to Illinois Compiled Statutes, 50 ILCS 105/3, et seq.

IN WITNESS WHEREOF, the parties hereto have executed this agreement by their respective officers, there unto duly authorized at Bloomington, Illinois, this 21st day of October, 2003.

APPROVED:

YWCA of McLEAN COUNTY

COUNTY OF McLEAN

By: _____

By: _____
Chairman, McLean County Board

ATTEST:

By: _____

By: _____
Clerk of the McLean County Board

YWCA04.Doc

LEASE AGREEMENT

Between

The County of McLean

As Landlord

And

**Board of Election Commissioners
City of Bloomington**

As Tenant

For

**Office Space Located on the 4th Floor of
200 W. Front Street, Bloomington, Illinois**

Table of Contents

	<u>Page</u>
1. <u>Term.</u>	1
2. <u>Rent.</u>	1
3. <u>Tenant's Use and Operation.</u>	1
4. <u>Utilities.</u>	1
5. <u>Building Common Areas.</u>	1
6. <u>Maintenance and Repair.</u>	2
7. <u>Parking.</u>	2
8. <u>Alterations.</u>	2
9. <u>Insurance and Indemnity.</u>	2
10. <u>Conduct.</u>	4
11. <u>Signs.</u>	4
12. <u>Estoppel.</u>	4
13. <u>Access to Premises.</u>	4
14. <u>Hazardous Material.</u>	4
15. <u>Condemnation.</u>	5
16. <u>Destruction.</u>	5
17. <u>Insolvency.</u>	6
18. <u>Assignment and Subletting.</u>	6
19. <u>Default.</u>	6
20. <u>Termination; Surrender of Possession.</u>	7
21. <u>Waiver.</u>	7

22. <u>Notices.</u>	8
23. <u>Agency.</u>	8
24. <u>Partial Invalidity.</u>	8
25. <u>Holding Over.</u>	9
26. <u>Successors.</u>	9
27. <u>Right to Terminate.</u>	9
28. <u>Non-Affiliation Clause.</u>	9
Approval Signatures	9

Lease Agreement

WHEREAS, the County of McLean, a body corporate and politic, (hereinafter referred to as "COUNTY"), as landlord, and the Board of Election Commissioners for the City of Bloomington (hereinafter referred to as "BEC"), as tenant, desire to continue a lease agreement for office space consisting of 2,564 s.f. located on the northeast side of the fourth floor of the 200 W. Front Street Building, Bloomington, Illinois (hereinafter referred to as "BUILDING"); and,

WHEREAS, this lease agreement expressly sets forth the rights and duties of each party,

NOW THEREFORE, it is expressly agreed as follows:

1. **Term.** The term of the lease agreement shall commence on **January 1, 2004**, and terminate on **December 31, 2004**.

2. **Rent.**
 - a. Rent shall be \$14,472.24 per year, payable in twelve equal monthly installments of **\$1,206.02**.

 - b. All rent payments shall be mailed to the below address:

**McLean County Treasurer
104 W. Front Street, Suite 706
Bloomington, Illinois 61702-2400**

 - c. The monthly rent payment during each month of the term of the lease shall be due and payable commencing on the first day of each month.

3. **Tenant's Use and Operation.** BEC shall use the aforementioned leased premises only for the purposes of its general business office. BEC shall not use the premises for any unlawful, improper, or immoral use, nor for any purpose or in any manner which is in violation of any present or future governmental law or regulation. BEC shall, during the term of the lease agreement, continuously use the leased premises for the purposes stated herein.

4. **Utilities.** COUNTY shall provide all utilities except telephone and data.

5. **Building Common Areas.** BEC shall be entitled to use of the areas designated from time to time by COUNTY as "common areas", and which are adjacent to or benefit the leased premises. Such common areas shall include adjoining sidewalks, entryway lobby, and lobby atrium areas for the purpose of egress and ingress of BEC employees and clients. Such use shall be subject to the rules and regulations, as COUNTY shall from time to time issue.

6. **Maintenance and Repair.** COUNTY shall be responsible for compliance with all building codes, the American's with Disabilities Act (as to permanent improvements only) and any other environmental or building safety issues and any state, local, and federal regulations relating thereto, perform all general building maintenance and repair. Notwithstanding the foregoing, COUNTY shall not be responsible for the cost of repairs and maintenance caused by intentional acts or negligence of BEC employees, agents, or clients. BEC shall keep the interior of premises as well as any portion of the leased premises visible from the exterior clear, orderly, and in good condition and repair, at its own expense. BEC shall keep all glass areas of leased premises clean which are visible from the BUILDING common area hallways. BEC shall be responsible for their own custodial needs, equipment, and supplies and the replacement cost of ceiling mounted light fixture lamps.
7. **Parking.** COUNTY shall provide no parking stalls to BEC.
8. **Alterations.** No alterations, additions, or improvements shall be made in or to the leased premises by BEC without the prior express written approval of COUNTY. All alterations, additions, improvements, and fixtures which may be made or installed by either of the parties hereto upon the leased premises and which in any manner are attached to the floors, walls, or ceiling, with the exception of BEC displays and trade fixtures, shall be the property of COUNTY and at the termination of this lease shall remain upon and be surrendered with the leased premises as a part thereof, without disturbance, molestation or injury. Notwithstanding the foregoing, COUNTY may designate by written notice to BEC certain fixtures, trade fixtures, alterations and additions to the leased premises which shall be removed by BEC at the expiration of this lease agreement. The parties hereto may also agree in writing, prior to the installation or construction of any alterations, improvements, or fixtures to the leased premises by BEC that BEC may either cause the removal of such items at the time of expiration of this lease, or that they may be left in the leased premises. BEC shall, at its own expense, repair any damages to the leased premises caused by the removal of its fixtures or alterations.
9. **Insurance and Indemnity.**
 - a. **Covenants to Hold Harmless.** BEC agrees to save and hold harmless COUNTY (including its officials, agents, and employees) free and harmless from all liability, public or private, penalties, contractual or otherwise, losses, damages, costs, attorney's fees, court costs, expenses, causes of action, claims or judgements, resulting from claimed natural persons and any other legal entity, or property of any kind (including, but not limited to choses in action) arising out of or in any way connected with this undertaking, whether or not arising out of the partial or sole negligence of COUNTY or its officials, agents, or employees, and shall indemnify COUNTY from any costs, expenses, judgements, and attorney's

fees paid or incurred by or on behalf of COUNTY and/or its agents and employees.

- b. **Fire and Casualty Insurance.** COUNTY shall be responsible for obtaining and maintaining a policy of fire and casualty insurance with extended coverage provisions applicable to the leased premises and protecting COUNTY against loss due to the structure of the premises. BEC shall be responsible for obtaining and maintaining a policy for fire and casualty insurance protecting BEC against loss or damage to its furnishings, equipment, and personal property in or on the leased premises.
- c. **Added Risk.** BEC shall also pay any increase in the fire and casualty insurance rates or premiums on the leased premises caused by any increased risk or hazardous business carried on by BEC in the leased premises. The determination of the insurance carrier shall be binding upon the parties as to the added risk resulting from BEC business. BEC's share of the annual insurance premiums for such insurance, as required by this paragraph, shall be paid within ten (10) days after BEC is given written request for same. COUNTY shall bill BEC without notice or negotiation for any rate increase.
- d. **Obligation to Carry Public Liability Insurance.** BEC shall, during the entire term hereof, keep in full force a policy of public liability insurance with respect to the leased premises and the business operated by BEC in the leased premises, and in which the limits of liability shall not be less than One Million Dollars (\$1,000,000.00), for personal injuries to any person or persons arising out of a single accident and Five Hundred Thousand Dollars (\$500,000.00) for property damage resulting from any one occurrence. COUNTY shall be named as an additional insured in all policies of liability insurance maintained pursuant to this provision. BEC shall furnish COUNTY a Certificate of Insurance of evidence of insurance that such insurance is in force at all times during the term of the lease. BEC shall furnish COUNTY additional certificates of BEC's insurance within twenty (20) days of receipt of a written request from COUNTY for such certificate.

Insurance shall be in a form acceptable to COUNTY and written by an insurance company admitted in the state of Illinois for such coverage.

- e. **Waiver of Subrogation Rights Under Insurance Policies.** Notwithstanding anything to the contrary contained herein, each of the parties hereto releases the other, and other tenants in BUILDING, to the extent of each party's insurance coverage, from any liability for any loss or damage which may be inflicted upon the property of such party even if such loss or damage shall be brought about by the fault or negligence of the other party, or other tenants, or their agents, employees or assigns; provided, however, that this release shall be effective only

with respect to loss or damage occurring during such time as the appropriate policy of insurance contains a clause to the effect that this release shall not affect the policy or the right of the insured to recover thereunder.

10. **Conduct.** BEC shall not cause or permit any conduct to take place within the leased premises which in any way disturbs or annoys other tenants or occupants of BUILDING, or adjacent buildings.
11. **Signs.** No sign, banner, decoration, picture, advertisement, awning, merchandise, or notice on the outside of leased premises or BUILDING, or which can be seen from the outside of leased premises, shall be installed or maintained by BEC without the prior express written approval of COUNTY.
12. **Estoppel.** Each party, within ten (10) days after notice from the other party, shall execute to the other party, in recordable form, a certificate stating that this lease is unmodified and in full force and effect, or in full force and effect as modified, and stating the modifications. The certificate shall also state the number of the base rental, the date to which the rent has been paid in advance, and the amount of any security deposit or prepaid rent. Failure to deliver the certificate within the ten (10) days shall be conclusive upon the party failing to so deliver for the benefit of the party requesting the certificate and any successor to the party so requesting, that this lease is in full force and effect and has not been modified except as may be represented by the party requesting the certificate.
13. **Access to the Premises.** COUNTY shall have the right to enter upon the leased premises at anytime for the purpose of inspecting the same, or of making repairs, or alternations to the leased premises or any property owned or controlled by COUNTY. For a period commencing one hundred twenty (120) days prior to the termination of this lease, COUNTY may have reasonable access to the leased premises for the purpose of exhibiting the same to prospective tenants.
14. **Hazardous Material.**
 - a. **Prohibition.** BEC expressly covenants and agrees that it will not cause or permit to be brought to, produced upon, disposed of or stored at the leased premises an hazardous material. For purposes of this provision, hazardous material shall mean any substance, in any form which is regulated or prohibited by statute, regulation, ordinance or rule including, but not limited to the Comprehensive Environmental Response, Comprehensive and Liability Act, 42 USC 6901, et seq. and regulations promulgated thereunder; the Toxic Substances Control Act, 15 USC 2601, et seq. and regulations promulgated thereunder; of the state of Illinois statutes; or any substance which may be harmful to human health or welfare or the environment.

- b. **Disclosure, Remediation, Liability, and Indemnification.** BEC expressly covenants and agrees that in the event any hazardous material is produced or stored at, brought to, or released on the leased premises, its agents, employees, invitees, clients, or licensees, or by the negligence of BEC, its agents, employees, invitees, clients, or licensees,
- (i) BEC shall immediately notify COUNTY of the event;
 - (ii) BEC shall take immediate preventive measures to abate the presence of hazardous materials at the leased premises;
 - (iii) BEC shall remediate and clean up the leased premises to COUNTY's satisfaction;
 - (iv) BEC shall be solely liable for all costs for removal of any hazardous material and for cleanup of the leased premises; and
 - (v) BEC shall be solely liable for damages arising from any such hazardous materials and does expressly indemnify and hold harmless COUNTY from any claims, liability, expenses or damages, fines, penalties or costs (including actual or incurred attorney's fees) therefor.
- c. **Survival.** BEC expressly covenants and agrees that the duties, obligations, and liabilities of BEC under the preceding section 14(a) and 14(b) shall survive the termination of this lease, and are binding upon BEC and its successors and assigns.
15. **Condemnation.** In the event a part of the leased premises shall be taken under the power of eminent domain by any legally constituted authority, and there remains a sufficient amount of space to permit BEC to carry on its business in a manner comparable to which it has become accustomed, then this lease shall continue, but the obligation to pay rent on the part of BEC shall be reduced in an amount proportionate to the area and relative value of the entire premises taken by such condemnation. In the event all of the leased premises shall be taken, or so much of the leased premises is taken that it is not feasible to continue a reasonably satisfactory operation of the business of BEC, then the lease shall be terminated. Such termination shall be without prejudice to the rights of either COUNTY or BEC to recover compensation from the condemning authority for any loss or damage caused by such condemnation. Neither COUNTY nor BEC shall have any right in or to any award made to the other by the condemning authority.
16. **Destruction.** Except as otherwise provided in this lease, in the event the leased premises are damaged by fire or other casualty covered by the insurance required herein, such damage shall be repaired with reasonable dispatch by and at the expense of COUNTY. Until such repairs are completed, the rent payable hereunder shall be

abated in proportion to the area of the leased premises which is rendered untenable by BEC in the conduct of its business. In the event that such repairs cannot, in the reasonable opinion of the parties, be substantially completed within one hundred twenty (120) days after the occurrence of such damage, or if more than fifty percent (50%) of the leased premises have been rendered unoccupiable as a result of such damage, or if there has been a declaration of any governmental authority that the leased premises are unsafe or unfit for occupancy, then COUNTY or BEC shall have the right to terminate this lease, or any extensions thereof.

17. **Insolvency.** Neither this lease nor any interest therein, nor any estate thereby created, shall pass to any trustee or receiver or assignee for the benefit of creditors or otherwise by operation of law. In the event the estate created hereby shall be taken in execution or by other process of law, or if BEC shall be adjudicated insolvent pursuant to the provisions of any state or insolvency act, or if a receiver or trustee of the property of BEC shall be appointed by reason of BEC's insolvency or inability to pay its debts, or if any assignment shall be made of BEC's property for the benefit of creditors, then and in any such event, COUNTY, may at its option, terminate this lease, or any extensions thereof, and all rights of BEC hereunder, by giving BEC notice in writing of the election of COUNTY to so terminate.
18. **Assignment and Subletting.** BEC shall not assign or in any manner transfer this lease or any estate or interest herein without the express previous consent of COUNTY.
19. **Default.** If BEC shall fail to make any payment of any rent due hereunder within five (5) days of its due date, or if default shall continue in the performance of any of the other covenants or conditions which BEC is required to observe and perform under this lease for a period of thirty (30) days following written notice of such failure, or if BEC shall abandon or vacate the premises during the term of this lease, or if BEC shall cease to entirely own all business operations being carried on upon the premises, then COUNTY may, but need not, treat the occurrence of any one or more of the foregoing events as a breach of this lease, and thereupon may, at its option, without notice or demand of any kind to BEC have any one or more of the following described remedies in addition to all other rights and remedies provided at law or in equity:
 - a. Terminate this lease, or any extension thereof, repossess the leased premises, and be entitled to recover immediately, as liquidated agreed final damages, the total amount due to be paid by BEC during the balance of the term of this lease, or any extensions thereof, less the fair rental value of the premises for said period, together with any sum of money owed by BEC to COUNTY.

- b. Without waiving its right to terminate this lease, or any extensions thereof, terminate BEC's right of possession and repossess the leased premises without demand or notice of any kind to BEC, in which case COUNTY may relet all or any part of the leased premises. BEC shall be responsible for all costs of reletting. BEC shall pay COUNTY on demand any deficiency from such reletting of COUNTY's inability to do so.
- c. Have specific performance of BEC's obligations.
- d. Cure the default and recover the cost of curing the same being on demand.

20. Termination; Surrender of Possession.

- a. Upon the expiration or termination of this lease, or any extension thereof, BEC shall:
 - (i) Restore the leased premises to their condition at the beginning of the term (other than as contemplated by paragraph (8) of this lease), ordinary wear and tear excepted, remove all of its personal property and trade fixtures from the leased premises and the property and repair any damage caused by such removal;
 - (ii) Surrender possession of the leased premises to COUNTY; and
 - (iii) Upon the request of COUNTY, at BEC's cost and expense, remove from the property all signs, symbols and trademarks pertaining to BEC's business and repair any damages caused by such removal; and
- b. If BEC shall fail or refuse to restore the leased premises as hereinabove provided, COUNTY may do so and recover its cost for so doing. COUNTY may, without notice, dispose of any property of BEC left upon the leased premises in any manner that COUNTY shall choose without incurring liability to BEC or to any other person. The failure of BEC to remove any property from the leased premises shall forever bar BEC from bringing any action or asserting any liability against COUNTY with respect to such property.

21. **Waiver.** One or more waivers of any covenant or condition by COUNTY shall not be construed as a waiver of a subsequent breach of the same covenant, and the consent or approval by COUNTY to or of any act of BEC requiring COUNTY's consent or approval shall not be deemed to waive or render unnecessary COUNTY's consent or approval to or of any subsequent act by BEC.

22. **Notices.** All notices, requests, demands and other communications required or permitted to be given hereunder shall be in writing and shall be deemed to have been given if delivered personally, or if sent by first-class mail, postage prepaid, return receipt requested to the following, or to such other address as shall be furnished in writing to one party by the other:

If to COUNTY:

Office of the County Administrator
McLean County
104 W. Front Street, Suite 701
P.O. Box 2400
Bloomington, Illinois 61702-2400

With Copies to:

Director, Facilities Management
McLean County
104 W. Front Street
P.O. Box 2400
Bloomington, Illinois 61702-2400

If to BEC:

Executive Director
Bloomington Board of Election Commissioners
200 W. Front Street, 4th Floor
Bloomington, Illinois 61701

23. **Agency.** Nothing contained herein shall be deemed or construed by the parties hereto, nor by any third party, as creating the relationship of principal and agent or partnership or of joint venture between the parties hereto, it being understood and agreed that neither the method of computation of rent, nor any other provision contained herein, nor any facts of the parties herein, shall be deemed to create any relationship between the parties hereto other than the relationship of landlord and tenant. Whenever herein the singular number is used, the same shall include the plural, and the masculine gender shall include the feminine and neuter genders.
24. **Partial Invalidity.** If any term or condition of this lease, or any extensions thereof, or the application thereof to any person or circumstance shall, to any extent, be invalid or unenforceable, the remainder of this lease, or any extension thereof, or the application of such term, covenant, or condition to persons or circumstances other than those as to which it is held invalid or unenforceable, shall not be affected thereby and each term, covenant, or condition of this lease shall be valid and be enforced to the fullest extent permitted by law.

25. **Holding Over.** Any holding over after the expiration of the term thereof with or without the consent of COUNTY, shall be construed to be a tenancy from month to month at the rents herein specified (prorated on a monthly basis) and shall otherwise be on the terms and conditions herein specified, so far as applicable.

26. **Successors.** All rights and liabilities herein given to, or imposed upon, the respective parties hereto shall extend to and bind the several respective heirs, executors, administrators, successors and assigns of the said parties; and if there shall be more than one tenant, they shall all be bound jointly and severally by the terms, covenants, and agreements herein. No rights, however, shall inure to the benefit of any assignee of BEC unless the assignment to such assignee has been approved by COUNTY in writing as provided herein.

27. **Right to Terminate.** Notwithstanding any other provision of this lease to the contrary, either party shall have the right to terminate this lease during the initial term or any extension term by giving at least one hundred twenty (120) days prior written notice of termination to the other party, by abiding by paragraph 22, page eight (8), of this lease pertaining to all notices.

28. **Non-Affiliation Clause.** No member of the McLean County Board or any other COUNTY official shall have an interest in any contract let by the McLean County Board either as a contractor or subcontractor pursuant to Illinois Compiled Statutes, 50 ILCS 105/3, et seq.

IN WITNESS WHEREOF, the parties hereto have executed this agreement by their respective officers, there unto duly authorized at Bloomington, Illinois, this 21st day of October, 2003.

APPROVED:

**BLOOMINGTON BOARD OF
ELECTION COMMISSIONERS**

By: _____

COUNTY OF McLEAN

By: _____
Chairman, McLean County Board

ATTEST:

By: _____

By: _____
Clerk of the McLean County Board

BBECOMM04.DOC

LEASE AGREEMENT

Between

The County of McLean

as Landlord,

and

Children's Advocacy Center

as Tenant,

for

**Office Space Located on the 5th Floor of
200 West Front Street, Bloomington, Illinois**

Table of Contents

	<u>Page</u>
1. <u>Term</u>	1
2. <u>Tenant's Use and Operation</u>	1
3. <u>Utilities</u>	1
4. <u>Building Common Areas</u>	1
5. <u>Maintenance and Repair</u>	2
6. <u>Parking</u>	2
7. <u>Alterations</u>	2
8. <u>Insurance and Indemnity</u>	3
a. <u>Covenants to Hold Harmless</u>	3
b. <u>Fire and Casualty Insurance</u>	3
c. <u>Added Risk</u>	3
d. <u>Obligation to Carry Public Liability Insurance</u>	3
e. <u>Waiver of Subrogation Rights Under Insurance Policies</u>	4
9. <u>Conduct</u>	4
10. <u>Signs</u>	4
11. <u>Estoppel</u>	4
12. <u>Access to the Premises</u>	5
13. <u>Hazardous Material</u>	5
a. <u>Prohibition</u>	5
b. <u>Disclosure, Remediation, Liability, and Indemnification</u>	5
c. <u>Survival</u>	6
14. <u>Condemnation</u>	6
15. <u>Destruction</u>	6

16.	<u>Insolvency</u>	6
17.	<u>Assignment and Subletting</u>	7
18.	<u>Default</u>	7
19.	<u>Termination; Surrender of Possession</u>	8
20.	<u>Waiver</u>	8
21.	<u>Notices</u>	8
22.	<u>Agency</u>	9
23.	<u>Partial Invalidity</u>	9
24.	<u>Holding Over</u>	9
25.	<u>Successors</u>	9
26.	<u>Right to Terminate</u>	10
27.	<u>Non-Affiliation Clause</u>	10
	Approval Signatures	10

Lease Agreement

WHEREAS, the County of McLean, a body corporate and politic, (hereinafter "COUNTY") as Landlord, and the Children's Advocacy Center (hereinafter "CAC"), as Tenant, desire to terminate the lease agreement for 2,358 s.f. of office space located on the second floor of the McBarnes Memorial Building, 201 E. Grove Street, Bloomington, Illinois, and enter into a new lease agreement for 8,027 s.f. of office space located on the fifth floor of the 200 W. Front Street Building, Bloomington, Illinois, (hereinafter "Building"); and,

WHEREAS, the parties herein mutually agree that this agreement expressly sets forth the rights and duties of each party,

NOW THEREFORE, it is expressly agreed as follows:

Term. The term of this lease agreement shall commence on **January 1, 2004**, and terminate on **December 31, 2004**.

Further, it is mutually agreed by the parties that all previous leases entered into between CAC and COUNTY are hereby null and void on the date CAC occupies the office space on the 5th floor of BUILDING.

2. **Tenant's Use and Operation.** CAC shall use the aforementioned leased premises only for the purposes of its general business office. CAC shall not use the premises for any unlawful, improper or immoral use, nor for any purpose or in any manner which is in violation of any present or future governmental law or regulation, and shall, at all times, be in compliance with the City of Bloomington Fire Code. CAC shall, during the initial term of the lease, continuously use the leased premises for the purposes stated herein.
3. **Utilities.** CAC agrees to pay COUNTY its proportionate share of all utilities and maintenance expenses for the leased premises, to be billed to CAC by COUNTY on a monthly basis, for electricity, natural gas, water, trash removal, elevator maintenance contract fees, alarm monitoring fees, labor for maintenance expenses, and any supplies costs or materials costs as may be requested from time to time by CAC. CAC shall be responsible for its own telephone and data expenses. Payment to COUNTY by CAC for monthly invoices is due and payable upon receipt by CAC.
4. **Building Common Areas.** CAC shall be entitled to use of the areas designated from time to time by COUNTY as "common areas", and which are adjacent to or benefit the leased premises. Such common areas shall include COUNTY designated "customer only" parking areas at BUILDING, adjoining sidewalks, entryway lobby, and atrium areas for the purpose of egress and ingress of CAC employees and clients.

Such use shall be subject to the rules and regulations as COUNTY shall from time to time issue.

5. **Maintenance and Repair.** COUNTY shall be responsible for compliance with all building codes, the American's with Disabilities ACT (as to permanent improvements only) and any other environmental or building safety issues and the state, local, and federal regulations relating thereto, perform all general building maintenance and repair. Notwithstanding the foregoing, COUNTY shall not be responsible for the cost of repairs and maintenance caused by the intentional acts or negligence of CAC or its Board, employees or clients. CAC shall keep the interior of premises as well as any portion of the leased premises visible from the exterior clear, orderly, and in good condition and repair, at its own expense. CAC shall keep all glass areas of leased premises clean which are visible from the BUILDING common area hallways. CAC shall be responsible for the repair costs for any damage or graffiti done to BUILDING caused by the clients of CAC. CAC shall be billed for all labor and materials used to repair any damage or graffiti caused by clients of CAC. Such bills shall be payable within 30 days of receipt of repair invoice by CAC.
6. **Parking.** COUNTY shall provide no parking stalls for CAC, and further, CAC agrees to not park any employee vehicles at any time in the lot adjacent to BUILDING under penalty of removal of said vehicle(s) at owners expense.
7. **Alterations.** No alterations, additions or improvements shall be made in or to the leased premises without the prior express written approval of COUNTY. All alterations, additions, improvements, and fixtures which may be made or installed by either of the parties hereto upon the leased premises and which in any manner are attached to the floors, walls or ceilings, shall be the property of COUNTY and at the termination of this agreement, shall remain upon and be surrendered with the leased premises as a part thereof, without disturbance, molestation or injury. Notwithstanding the foregoing, COUNTY may designate by written notice to CAC certain fixtures, trade fixtures, alterations and additions to the leased premises which shall be removed by CAC at the expiration of this agreement. The parties hereto may also agree in writing, prior to the installation or construction of any alternations, improvements, or fixtures to the leased premises by CAC or its Board may either cause the removal of such items at the time of expiration of this lease, or that they may be left in the leased premises. CAC shall, at its own expense, repair any damages to the leased premises caused by the removal of its fixtures or alternations.

8. **Insurance and Indemnity.**

a. **Covenants to Hold Harmless.** CAC agrees to save and hold COUNTY (including its officials, agents, and employees) free and harmless from all liability, public or private, penalties, contractual or otherwise, losses, damages, costs, attorney's fees, court costs, expenses, causes of action, claims or judgements, resulting from claimed natural persons and any other legal entity, or property of any kind including, but not limited to choses in action) arising out of or in any way connected with this undertaking, whether or not arising out of the partial or sole negligence of COUNTY or its officials, agents, or employees, and shall indemnify COUNTY from any costs, expenses, judgements, and attorney's fees paid or incurred by or on behalf of COUNTY and/or its agents and employees.

b. **Fire and Casualty Insurance.** COUNTY shall be responsible for obtaining and maintaining a policy of fire and casualty insurance with extended coverage provisions applicable to the leased premises and protecting COUNTY against loss due to the structure of the premises. CAC shall be responsible for obtaining and maintaining a policy for fire and casualty insurance protecting CAC against loss or damage to its furnishings, equipment, and personal property in or on the leased premises.

c. **Added Risk.** CAC shall also pay any increase in the fire and casualty insurance rates or premiums on the leased premises caused by any increased risk or hazardous business carried on by CAC in the leased premises. The determination of the insurance carrier shall be binding upon the parties as to the added risk resulting from CAC business. CAC's share of the annual insurance premiums for such insurance, as required by this paragraph, shall be paid within ten (10) days after CAC is given written request for same. COUNTY shall invoice CAC without notice or negotiation for any rate increase.

d. **Obligation to Carry Public Liability Insurance.** CAC shall, during the entire term hereof, keep in full force a policy of public liability insurance with respect to the leased premises and the business operated by CAC in the leased premises, and in which the limits of liability shall not be less than One Million Dollars (\$1,000,000.00), for personal injuries to any person or persons arising out of a single accident and Five Hundred Thousand Dollars (\$500,000.00) for property damage resulting from any one occurrence. COUNTY shall be named as an additional insured in all policies of liability insurance maintained pursuant to this provision. CAC shall furnish COUNTY a Certificate of Insurance as evidence of insurance that such

insurance is in force at all times during the initial term of this agreement. CAC shall furnish COUNTY additional certificates of CAC's insurance within twenty (20) days of receipt of a written request by COUNTY for such certificate. Insurance must be in a form acceptable to COUNTY and written by an insurance company admitted in the state of Illinois for such coverage.

e. **Waiver of Subrogation Rights Under Insurance Policies.**

Notwithstanding anything to the contrary contained herein, each of the parties hereto releases the other, and other tenants in BUILDING, to the extent of each party's insurance coverage, from any and all liability for any loss or damage which may be inflicted upon the property of such party even if such loss or damage shall be brought about by the fault or negligence of the other party, or other tenants, or their agents, employees or assigns; provided, however, that this release shall be effective only with respect to loss or damage occurring during such time as the appropriate policy of insurance contains a clause to the effect that this release shall not affect the policy or the right of the insured to recover thereunder.

9. **Conduct.** CAC shall not cause or permit any conduct of employees or clients of CAC to take place within the leased premises or building which in any way may disturb or annoy other tenants or occupants of BUILDING or adjacent buildings.
10. **Signs.** No sign, banner, decoration, picture, advertisement, awning, merchandise, or notice on the outside of leased premises or BUILDING, or which can be seen from the outside of leased premises, shall be installed or maintained by CAC without the prior express written approval of COUNTY.
11. **Estoppel.** Each party, within ten (10) days after notice from the other party, shall execute to the other party, in recordable form, a certificate stating that this lease is unmodified and in full force and effect, or in full force and effect as modified, and stating the modifications. The certificate shall also state the amount of the base rental, if applicable, the date to which the rent has been paid in advance, and the amount of any security deposit or prepaid rent. Failure to deliver the certificate within the ten (10) days shall be conclusive upon the party failing to so deliver for the benefit of the party requesting the certificate and any successor to the party so requesting, that this lease is in full force and effect and has not been modified except as may be represented by the party requesting the certificate.

12. **Access to the Premises.** COUNTY shall have the right to enter upon the leased premises at anytime for the purpose of inspecting the same, or of making repairs, additions or alterations to the leased premises or any property owned or controlled by COUNTY. For a period commencing one hundred twenty (120) days prior to the termination of this lease, COUNTY may have reasonable access to the leased premises for the purpose of exhibiting the same to prospective tenants with 24 hours notice to CAC.
13. **Hazardous Material.**
- a. **Prohibition.** CAC expressly covenants and agrees that it will not cause or permit to be brought to, produced upon, disposed of or stored at the leased premises an hazardous material. For purposes of this provision, hazardous material shall mean any substance, in any form which is regulated or prohibited by statute, regulation, ordinance or rule including, but not limited to the Comprehensive Environmental Response, Compensation and Liability Act, 42 USC 6901, et seq. and regulations promulgated thereunder; the Toxic Substances Control Act, 15 USC 2601, et seq. and regulations promulgated thereunder; of state of Illinois statutes; or any substance which may be harmful to human health or welfare or the environment.
- b. **Disclosure, Remediation, Liability, and Indemnification.** CAC expressly covenants and agrees that in the event any hazardous material is produced or stored at, brought to, or released on the leased premises by CAC, its agents, employees, invitees, clients, or licensees, or by the negligence of CAC, its agents, employees, invitees, clients, or licensees,
- (i) CAC shall immediately notify COUNTY of the event;
 - (ii) CAC shall take immediate preventive measures to abate the presence of hazardous materials at the leased premises;
 - (iii) CAC shall remediate and clean up the leased premises to COUNTY's satisfaction;
 - (iv) CAC shall be solely liable for all costs for removal of any hazardous material and for cleanup of the leased premises; and
 - (v) CAC shall be solely liable for damages arising from any such hazardous materials and does expressly indemnify and hold harmless COUNTY from any claims, liability, expenses or damages, fines, penalties or costs (including actual or incurred attorney's fees) therefor.

c. **Survival.** CAC expressly covenants and agrees that the duties, obligations, and liabilities of CAC under the preceding section 13(a) and 13(b) shall survive the termination of this lease, and are binding upon CAC and its successors and assigns.

14. **Condemnation.** In the event a part of the leased premises shall be taken under the power of eminent domain by any legally constituted authority, and there remains a sufficient amount of space to permit CAC to carry on its business in a manner comparable to which it has become accustomed, then this lease shall continue, but the obligation to pay rent on the part of CAC shall be reduced in an amount proportionate to the area and relative value of the entire premises taken by such condemnation. In the event all of the leased premises shall be taken, or so much of the leased premises is taken that it is not feasible to continue a reasonably satisfactory operation of the business of CAC, then the lease shall be terminated. Such termination shall be without prejudice to the rights of either COUNTY or CAC to recover compensation from the condemning authority for any loss or damage caused by such condemnation. Neither COUNTY nor CAC shall have any right in or to any award made to the other by the condemning authority.
15. **Destruction.** Except as otherwise provided in this lease, in the event the leased premises are damaged by fire or other casualty covered by the insurance required herein, such damage shall be repaired with reasonable dispatch by and at the expense of COUNTY. Until such repairs are completed, the rent payable hereunder shall be abated in proportion to the area of the leased premises which is rendered untenable by CAC in the conduct of its business. In the event that such repairs cannot, in the reasonable opinion of the parties, be substantially completed within one hundred twenty (120) days after the occurrence of such damage, or if more than fifty percent (50%) of the leased premises have been rendered unoccupiable as a result of such damage, or if there has been a declaration of any governmental authority that the leased premises are unsafe or unfit for occupancy, then COUNTY or CAC shall have the right to terminate this agreement, or any extensions thereof.
16. **Insolvency.** Neither this lease nor any interest therein, nor any estate thereby created, shall pass to any trustee or receiver or assignee for the benefit of creditors or otherwise by operation of law. In the event the estate created hereby shall be taken in execution or by other process of law, or if CAC shall be adjudicated insolvent pursuant to the provision of any state or insolvency act, or if a receiver or trustee of the property of CAC shall be

appointed by reason of CAC's insolvency or inability to pay its debts , or if any assignment shall be made of CAC's property for the benefit of creditors, then and in any such event, COUNTY, may at its option, terminate this lease, or any extensions thereof, and all rights of CAC hereunder, by giving CAC notice in writing of the election of COUNTY to so terminate.

17. **Assignment and Subletting.** CAC shall not assign or in any manner transfer this agreement or any estate or interest herein without the express written previous consent of COUNTY.
18. **Default.** If CAC shall fail to make any payment of any invoice due to COUNTY hereunder within five (5) days of its due date, or if default shall continue in the performance of any of the other covenants or conditions which CAC is required to observe and perform under this lease for a period of thirty (30) days following written notice of such failure, or if CAC shall abandon or vacate the premises during the term of this lease, or if CAC shall cease to entirely own all business operations being carried on upon the premises, then COUNTY may, but need not, treat the occurrence of any one or more of the foregoing events as a breach of this lease, and thereupon may, at its option, without notice or demand of any kind to CAC have any one or more of the following described remedies in addition to all other rights and remedies provided at law or in equity:
 - a. Terminate this lease, or any extensions thereof, repossess the leased premises, and be entitled to recover immediately, as liquidated agreed final damages, the total amount due to be paid by CAC during the balance of the initial term of this agreement, or any extensions thereof, less the fair rental value of the premises for said period, together with any sum of money owed by CAC to COUNTY.
 - b. Without waiving its right to terminate this lease, or any extensions thereof, terminate CAC's right of possession and repossess the leased premises without demand or notice of any kind to CAC, in which case COUNTY may relet all or any part of the leased premises. CAC shall be responsible for all costs of reletting. CAC shall pay COUNTY on demand any deficiency from such reletting or COUNTY's inability to do so.
 - c. Have specific performance of CAC's obligations.
 - d. Cure the default and recover the cost of curing the same being on demand.

19. **Termination; Surrender of Possession.**

a. Upon the expiration or termination of this lease, or any extension thereof, CAC shall:

(i) Restore the leased premises to their condition at the beginning of the term (other than as contemplated by paragraph seven (8) of this lease, ordinary wear and tear excepted, remove all of its personal property and trade fixtures from the leased premises and the property and repair any damage caused by such removal;

(ii) Surrender possession of the leased premises to COUNTY; and

(iii) Upon the request of COUNTY, at CAC's cost and expense, remove from the property all signs, symbols and trademarks pertaining to CAC's business and repair any damages caused by such removal.

b. If CAC shall fail or refuse to restore the leased premises as hereinabove provided, COUNTY may do so and recover its cost for so doing. COUNTY may, without notice, dispose of any property of CAC left upon the leased premises in any manner that COUNTY shall choose without incurring liability to CAC or to any other person. The failure of CAC to remove any property from the leased premises shall forever bar CAC from bringing any action or asserting any liability against COUNTY with respect to such property.

20. **Waiver.** One or more waivers of any covenant or condition by COUNTY shall not be construed as a waiver of a subsequent breach of the same covenant or condition, and the consent or approval by COUNTY to or of any act of CAC requiring COUNTY's consent or approval shall not be deemed to waive or render unnecessary COUNTY's consent or approval to or of any subsequent act by CAC.

21. **Notices.** All notices, requests, demands and other communications required or permitted to be given hereunder shall be in writing and shall be deemed to have been given if delivered personally, or if sent by first-class mail, postage prepaid, return receipt requested to the following, or to such other address as shall be furnished in writing to one party by the other:

If to COUNTY:

Office of the County Administrator
McLean County
104 W. Front Street, Suite 701
Bloomington, IL 61702-2400

With Copies to:

Director of Facilities Management
McLean County
104 W. Front Street, Suite 104
Bloomington, Illinois 61702-2400

If to CAC:

Executive Director
Children's Advocacy Center
200 W. Front Street, 5th Floor
Bloomington, Illinois 61701

22. **Agency.** Nothing contained herein shall be deemed or construed by the parties hereto, nor by any third party, as creating the relationship of principal and agent or partnership or of joint venture between the parties hereto, it being understood and agreed that neither the method of computation of utilities and maintenance reimbursement, nor any other provision contained herein, nor any acts of the parties herein, shall be deemed to create any relationship between the parties hereto other than the relationship of landlord and tenant. Whenever herein the singular number is used, the same shall include the plural, and the masculine gender shall include the feminine and neuter genders.
23. **Partial Invalidity.** If any term or condition of this lease, or any extension thereof, or the application thereof to any person or circumstance shall, to any extent, be invalid or unenforceable, the remainder of this lease, or any extension thereof, or the application of such term, covenant or condition to persons or circumstances other than those as to which it is held invalid or unenforceable, shall not be affected thereby and each term, covenant or condition of this lease shall be valid and be enforced to the fullest extent permitted by law.
24. **Holding Over.** Any holding over after the expiration of the term thereof, with or without the consent of COUNTY, shall be construed to be a tenancy from month to month at the rates herein specified (prorated on a monthly basis) and shall otherwise be on the terms and conditions herein specified, so far as applicable.
25. **Successors.** All rights and liabilities herein given to, or imposed upon, the respective parties hereto shall extend to and bind the several respective heirs, executors, administrators, successors and assigns of the said parties; and if there shall be more than one tenant, they shall all be bound jointly and severally by the terms, covenants and agreements herein. No rights, however, shall inure to the

benefit of any assignee of CAC unless the assignment to such assignee has been approved by COUNTY in writing as provided herein.

- 26. **Right to Terminate.** Notwithstanding any other provision of this lease to the contrary, either party shall have the right to terminate this lease during the initial term or any extension term by giving at least sixty (60) days prior written notice of termination to the other party, by abiding by paragraph 21, page eight of this agreement pertaining to all notices.
- 28. **Non-Affiliation Clause.** No member of the McLean County Board or any other COUNTY official shall have an interest in any contract let by the McLean County Board either as a contractor or subcontractor pursuant to Illinois Compiled Statutes, 50 ILCS 105/3, et seq.

IN WITNESS WHEREOF, the parties hereto have executed this agreement by their respective officers, there unto duly authorized at Bloomington, Illinois, this 21st day of October, 2003.

APPROVED:

Children's Advocacy Center

COUNTY OF McLEAN

By: _____
Executive Director

By: _____
Michael F. Sweeney, Chairman
of the McLean County Board

ATTEST:

By: _____

By: _____
Peggy Ann Milton, Clerk of
the McLean County Board

LEASE AGREEMENT

Between

The County of McLean

as Landlord,

and

McLean County States Attorney

as Tenant,

for

Office Space Located on the 4th Floor of
200 West Front Street, Bloomington, Illinois
For the Child Support Enforcement Division

Table of Contents

	<u>Page</u>
1. <u>Term</u>	1
2. <u>Rent</u>	1
a. Rent	1
b. Definition of Rent	1
c. Mailing Address for Rent Payments	1
d. Rent payment due date	1
3. <u>Tenant's Use and Operation</u>	1
4. <u>Utilities</u>	1
5. <u>Building Common Areas</u>	2
6. <u>Maintenance and Repair</u>	2
7. <u>Parking</u>	2
8. <u>Alterations</u>	2
9. <u>Insurance and Indemnity</u>	3
a. <u>Covenants to Hold Harmless</u>	3
b. <u>Fire and Casualty Insurance</u>	3
c. <u>Added Risk</u>	3
d. <u>Obligation to Carry Public Liability Insurance</u>	3
e. <u>Waiver of Subrogation Rights Under Insurance Policies</u>	4
10. <u>Conduct</u>	4
11. <u>Signs</u>	4
12. <u>Estoppel</u>	4
13. <u>Access to the Premises</u>	5

14.	<u>Hazardous Material</u>	5
	a. <u>Prohibition</u>	5
	b. <u>Disclosure, Remediation, Liability, and Indemnification</u>	5
	c. <u>Survival</u>	6
15.	<u>Condemnation</u>	6
16.	<u>Destruction</u>	6
17.	<u>Insolvency</u>	7
18.	<u>Assignment and Subletting</u>	7
19.	<u>Default</u>	7
20.	<u>Termination; Surrender of Possession</u>	8
21.	<u>Waiver</u>	8
22.	<u>Notices</u>	8
23.	<u>Agency</u>	9
24.	<u>Partial Invalidity</u>	9
25.	<u>Holding Over</u>	9
26.	<u>Successors</u>	9
27.	<u>Right to Terminate</u>	10
28.	<u>Non-Affiliation Clause</u>	10
	Approval Signatures	10

Lease Agreement

WHEREAS, the County of McLean, a body corporate and politic, (hereinafter "COUNTY") as Landlord, and the Child Support Enforcement Division of the McLean County States Attorney's office, (hereinafter "CSED"), as Tenant, desire to continue a lease agreement for office space located on the northwest corner of the fourth floor of the 200 W. Front Street building, Bloomington, Illinois, (hereinafter "Building"); and,

WHEREAS, the parties herein mutually agree that this agreement expressly sets forth the rights and duties of each party,

NOW THEREFORE, it is expressly agreed as follows:

1. **Term.** The term of this lease agreement shall commence on December 1, 2003, and terminate on June 30, 2004.
2. **Rent.**
 - a. Rent shall be or \$20,249.25 for 4,588 s.f. of office space, payable in seven equal monthly installments of \$2,892.75.
 - b. Rent, for purposes of this agreement, shall be defined as including all rent, utilities (except telephone services), and general maintenance.
 - c. All rent payments shall be mailed to the below address:

**McLean County Treasurer
P.O. Box 2400
Bloomington, Illinois 61702-2400**
 - d. The monthly rent payment during each month of the term thereof shall be payable commencing on the first day of each month.
3. **Tenant's Use and Operation.** CSED shall use the aforementioned leased premises only for the purposes of its general business office. CSED shall not use the premises for any unlawful, improper or immoral use, nor for any purpose or in any manner which is in violation of any present or future governmental law or regulation, and shall, at all times, be in compliance with the City of Bloomington Fire Code. CSED shall, during the initial term of the lease, continuously use the leased premises for the purposes stated herein.
4. **Utilities.** COUNTY shall provide all electricity, gas, water, and trash services used or consumed by CSED in the leased premises. CSED shall be responsible for the payment of its own telephone or data services.

5. **Building Common Areas.** CSED shall be entitled to use of the areas designated from time to time by COUNTY as "common areas", and which are adjacent to or benefit the leased premises. Such common areas shall include COUNTY designated "customer only" parking areas at BUILDING, adjoining sidewalks, entryway lobby, and atrium areas for the purpose of egress and ingress of CSED employees and clients. Such use shall be subject to the rules and regulations as COUNTY shall from time to time issue.

6. **Maintenance and Repair.** COUNTY shall be responsible for compliance with all building codes, the American's with Disabilities ACT (as to permanent improvements only) and any other environmental or building safety issues and the state, local, and federal regulations relating thereto, perform all general building maintenance and repair. Notwithstanding the foregoing, COUNTY shall not be responsible for the cost of repairs and maintenance caused by the intentional acts or negligence of CSED or its Board, employees or clients. CSED shall keep the interior of premises as well as any portion of the leased premises visible from the exterior clear, orderly, and in good condition and repair, at its own expense. CSED shall keep all glass areas of leased premises clean which are visible from the BUILDING common area hallways. COUNTY shall provide custodial cleaning services each weekday evening. CSED shall be responsible for the repair costs for any damage or graffiti done to BUILDING caused by the clients of CSED. CSED shall be billed for all labor and materials used to repair any damage or graffiti caused by clients of CSED. Such bills shall be payable within 30 days of receipt of repair invoice by CSED.

7. **Parking.** COUNTY shall provide no parking stalls for CSED, and further, CSED agrees to not park any employee vehicles at any time in the lot adjacent to BUILDING under penalty of removal of said vehicle(s) at owners expense.

8. **Alterations.** No alterations, additions or improvements shall be made in or to the leased premises without the prior express written approval of COUNTY. All alterations, additions, improvements, and fixtures which may be made or installed by either of the parties hereto upon the leased premises and which in any manner are attached to the floors, walls or ceilings, shall be the property of COUNTY and at the termination of this agreement, shall remain upon and be surrendered with the leased premises as a part thereof, without disturbance, molestation or injury. Notwithstanding the foregoing, COUNTY may designate by written notice to CSED certain fixtures, trade fixtures, alterations and additions to the leased premises which shall be removed by CSED at the expiration of this agreement. The parties hereto may also

agree in writing, prior to the installation or construction of any alternations, improvements, or fixtures to the leased premises by CSED or its Board may either cause the removal of such items at the time of expiration of this lease, or that they may be left in the leased premises. CSED shall, at its own expense, repair any damages to the leased premises caused by the removal of its fixtures or alternations.

9. **Insurance and Indemnity.**

a. **Covenants to Hold Harmless.** CSED agrees to save and hold COUNTY (including its officials, agents, and employees) free and harmless from all liability, public or private, penalties, contractual or otherwise, losses, damages, costs, attorney's fees, court costs, expenses, causes of action, claims or judgements, resulting from claimed natural persons and any other legal entity, or property of any kind including, but not limited to choses in action) arising out of or in any way connected with this undertaking, whether or not arising out of the partial or sole negligence of COUNTY or its officials, agents, or employees, and shall indemnify COUNTY from any costs, expenses, judgements, and attorney's fees paid or incurred by or on behalf of COUNTY and/or its agents and employees.

b. **Fire and Casualty Insurance.** COUNTY shall be responsible for obtaining and maintaining a policy of fire and casualty insurance with extended coverage provisions applicable to the leased premises and protecting COUNTY against loss due to the structure of the premises. CSED shall be responsible for obtaining and maintaining a policy for fire and casualty insurance protecting CSED against loss or damage to its furnishings, equipment, and personal property in or on the leased premises.

c. **Added Risk.** CSED shall also pay any increase in the fire and casualty insurance rates or premiums on the leased premises caused by any increased risk or hazardous business carried on by CSED in the leased premises. The determination of the insurance carrier shall be binding upon the parties as to the added risk resulting from CSED business. CSED's share of the annual insurance premiums for such insurance, as required by this paragraph, shall be paid within ten (10) days after CSED is given written request for same. COUNTY shall invoice CSED without notice or negotiation for any rate increase.

Obligation to Carry Public Liability Insurance. CSED shall, during the entire term hereof, keep in full force a policy of public liability insurance with respect to the leased premises and the business operated by CSED in the leased premises, and in which the limits of liability

shall not be less than One Million Dollars (\$1,000,000.00), for personal injuries to any person or persons arising out of a single accident and Five Hundred Thousand Dollars (\$500,000.00) for property damage resulting from any one occurrence. COUNTY shall be named as an additional insured in all policies of liability insurance maintained pursuant to this provision. CSED shall furnish COUNTY a Certificate of Insurance as evidence of insurance that such insurance is in force at all times during the term of this agreement. CSED shall furnish COUNTY additional certificates of CSED's insurance within twenty (20) days of receipt of a written request by COUNTY for such certificate. Insurance must be in a form acceptable to COUNTY and written by an insurance company admitted in the state of Illinois for such coverage.

e. **Waiver of Subrogation Rights Under Insurance Policies.**

Notwithstanding anything to the contrary contained herein, each of the parties hereto releases the other, and other tenants in BUILDING, to the extent of each party's insurance coverage, from any and all liability for any loss or damage which may be inflicted upon the property of such party even if such loss or damage shall be brought about by the fault or negligence of the other party, or other tenants, or their agents, employees or assigns; provided, however, that this release shall be effective only with respect to loss or damage occurring during such time as the appropriate policy of insurance contains a clause to the effect that this release shall not affect the policy or the right of the insured to recover thereunder.

10. **Conduct.** CSED shall not cause or permit any conduct of employees or clients of CSED to take place within the leased premises or building which in any way may disturb or annoy other tenants or occupants of BUILDING or adjacent buildings.
11. **Signs.** No sign, banner, decoration, picture, advertisement, awning, merchandise, or notice on the outside of leased premises or BUILDING, or which can be seen from the outside of leased premises, shall be installed or maintained by CSED without the prior express written approval of COUNTY.
12. **Estoppel.** Each party, within ten (10) days after notice from the other party, shall execute to the other party, in recordable form, a certificate stating that this lease is unmodified and in full force and effect, or in full force and effect as modified, and stating the modifications. The certificate shall also state the amount of the base rental, the date to which the rent has been paid in advance, and the amount of any security deposit or prepaid rent. Failure to deliver the certificate within the ten (10) days shall be

conclusive upon the party failing to so deliver for the benefit of the party requesting the certificate and any successor to the party so requesting, that this lease is in full force and effect and has not been modified except as may be represented by the party requesting the certificate.

13. **Access to the Premises.** COUNTY shall have the right to enter upon the leased premises at anytime for the purpose of inspecting the same, or of making repairs, additions or alterations to the leased premises or any property owned or controlled by COUNTY. For a period commencing one hundred twenty (120) days prior to the termination of this lease, COUNTY may have reasonable access to the leased premises for the purpose of exhibiting the same to prospective tenants with 24 hours notice to CSED.

14. **Hazardous Material.**

a. **Prohibition.** CSED expressly covenants and agrees that it will not cause or permit to be brought to, produced upon, disposed of or stored at the leased premises an hazardous material. For purposes of this provision, hazardous material shall mean any substance, in any form which is regulated or prohibited by statute, regulation, ordinance or rule including, but not limited to the Comprehensive Environmental Response, Compensation and Liability Act, 42 USC 6901, et seq. and regulations promulgated thereunder; the Toxic Substances Control Act, 15 USC 2601, et seq. and regulations promulgated thereunder; of state of Illinois statutes; or any substance which may be harmful to human health or welfare or the environment.

b. **Disclosure, Remediation, Liability, and Indemnification.** CSED expressly covenants and agrees that in the event any hazardous material is produced or stored at, brought to, or released on the leased premises by CSED, its agents, employees, invitees, clients, or licensees, or by the negligence of CSED, its agents, employees, invitees, clients, or licensees,

- (i) CSED shall immediately notify COUNTY of the event;
- (ii) CSED shall take immediate preventive measures to abate the presence of hazardous materials at the leased premises;
- (iii) CSED shall remediate and clean up the leased premises to COUNTY's satisfaction;
- (iv) CSED shall be solely liable for all costs for removal of any hazardous material and for cleanup of the leased premises; and

- (v) CSED shall be solely liable for damages arising from any such hazardous materials and does expressly indemnify and hold harmless COUNTY from any claims, liability, expenses or damages, fines, penalties or costs (including actual or incurred attorney's fees) therefor.

c. **Survival.** CSED expressly covenants and agrees that the duties, obligations, and liabilities of CSED under the preceding section 14(a) and 14(b) shall survive the termination of this lease, and are binding upon CSED and its successors and assigns.

15. **Condemnation.** In the event a part of the leased premises shall be taken under the power of eminent domain by any legally constituted authority, and there remains a sufficient amount of space to permit CSED to carry on its business in a manner comparable to which it has become accustomed, then this lease shall continue, but the obligation to pay rent on the part of CSED shall be reduced in an amount proportionate to the area and relative value of the entire premises taken by such condemnation. In the event all of the leased premises shall be taken, or so much of the leased premises is taken that it is not feasible to continue a reasonably satisfactory operation of the business of CSED, then the lease shall be terminated. Such termination shall be without prejudice to the rights of either COUNTY or CSED to recover compensation from the condemning authority for any loss or damage caused by such condemnation. Neither COUNTY nor CSED shall have any right in or to any award made to the other by the condemning authority.
16. **Destruction.** Except as otherwise provided in this lease, in the event the leased premises are damaged by fire or other casualty covered by the insurance required herein, such damage shall be repaired with reasonable dispatch by and at the expense of COUNTY. Until such repairs are completed, the rent payable hereunder shall be abated in proportion to the area of the leased premises which is rendered untenable by CSED in the conduct of its business. In the event that such repairs cannot, in the reasonable opinion of the parties, be substantially completed within one hundred twenty (120) days after the occurrence of such damage, or if more than fifty percent (50%) of the leased premises have been rendered unoccupiable as a result of such damage, or if there has been a declaration of any governmental authority that the leased premises are unsafe or unfit for occupancy, then COUNTY or CSED shall have the right to terminate this agreement, or any extensions thereof.

17. **Insolvency.** Neither this lease nor any interest therein, nor any estate thereby created, shall pass to any trustee or receiver or assignee for the benefit of creditors or otherwise by operation of law. In the event the estate created hereby shall be taken in execution or by other process of law, or if CSED shall be adjudicated insolvent pursuant to the provision of any state or insolvency act, or if a receiver or trustee of the property of CSED shall be appointed by reason of CSED's insolvency or inability to pay its debts, or if any assignment shall be made of CSED's property for the benefit of creditors, then and in any such event, COUNTY, may at its option, terminate this lease, or any extensions thereof, and all rights of CSED hereunder, by giving CSED notice in writing of the election of COUNTY to so terminate.

18. **Assignment and Subletting.** CSED shall not assign or in any manner transfer this agreement or any estate or interest herein without the express written previous consent of COUNTY.

19. **Default.** If CSED shall fail to make any payment of any rent due hereunder within five (5) days of its due date, or if default shall continue in the performance of any of the other covenants or conditions which CSED is required to observe and perform under this lease for a period of thirty (30) days following written notice of such failure, or if CSED shall abandon or vacate the premises during the term of this lease, or if CSED shall cease to entirely own all business operations being carried on upon the premises, then COUNTY may, but need not, treat the occurrence of any one or more of the foregoing events as a breach of this lease, and thereupon may, at its option, without notice or demand of any kind to CSED have any one or more of the following described remedies in addition to all other rights and remedies provided at law or in equity:
 - a. Terminate this lease, or any extensions thereof, repossess the leased premises, and be entitled to recover immediately, as liquidated agreed final damages, the total amount due to be paid by CSED during the balance of the initial term of this agreement, or any extensions thereof, less the fair rental value of the premises for said period, together with any sum of money owed by CSED to COUNTY.

Without waiving its right to terminate this lease, or any extensions thereof, terminate CSED's right of possession and repossess the leased premises without demand or notice of any kind to CSED, in which case COUNTY may relet all or any part of the leased premises. CSED shall

Page eight

be responsible for all costs of reletting. CSED shall pay COUNTY on demand any deficiency from such reletting or COUNTY's inability to do so.

- c. Have specific performance of CSED's obligations.
- d. Cure the default and recover the cost of curing the same being on demand.

20. **Termination; Surrender of Possession.**

a. Upon the expiration or termination of this lease, or any extension thereof, CSED shall:

- (i) Restore the leased premises to their condition at the beginning of the term (other than as contemplated by paragraph eight (8) of this lease), ordinary wear and tear excepted, remove all of its personal property and trade fixtures from the leased premises and the property and repair any damage caused by such removal;
- (ii) Surrender possession of the leased premises to COUNTY; and
- (iii) Upon the request of COUNTY, at CSED's cost and expense, remove from the property all signs, symbols and trademarks pertaining to CSED's business and repair any damages caused by such removal.

b. If CSED shall fail or refuse to restore the leased premises as hereinabove provided, COUNTY may do so and recover its cost for so doing. COUNTY may, without notice, dispose of any property of CSED left upon the leased premises in any manner that COUNTY shall choose without incurring liability to CSED or to any other person. The failure of CSED to remove any property from the leased premises shall forever bar CSED from bringing any action or asserting any liability against COUNTY with respect to such property.

21. **Waiver.** One or more waivers of any covenant or condition by COUNTY shall not be construed as a waiver of a subsequent breach of the same covenant or condition, and the consent or approval by COUNTY to or of any act of CSED requiring COUNTY's consent or approval shall not be deemed to waive or render unnecessary COUNTY's consent or approval to or of any subsequent act by CSED.

22. **Notices.** All notices, requests, demands and other communications required or permitted to be given hereunder shall be in writing and shall be deemed to have been given if delivered personally, or if sent by first-class mail, postage prepaid, return receipt requested to the following, or to such other address as shall be furnished in writing to one party by the other:

Page nine

If to COUNTY:

Office of the County Administrator
McLean County
104 W. Front Street, Suite 701
Bloomington, IL 61702-2400

With Copies to:

Director of Facilities Management
McLean County
104 W. Front Street, Suite 104
Bloomington, Illinois 61702-2400

If to CSED:

Administrative Attorney
Child Support Enforcement Division
200 W. Front Street, 4th Floor
Bloomington, Illinois 61701

23. **Agency.** Nothing contained herein shall be deemed or construed by the parties hereto, nor by any third party, as creating the relationship of principal and agent or partnership or of joint venture between the parties hereto, it being understood and agreed that neither the method of computation of rent, nor any other provision contained herein, nor any acts of the parties herein, shall be deemed to create any relationship between the parties hereto other than the relationship of landlord and tenant. Whenever herein the singular number is used, the same shall include the plural, and the masculine gender shall include the feminine and neuter genders.
24. **Partial Invalidity.** If any term or condition of this lease, or any extension thereof, or the application thereof to any person or circumstance shall, to any extent, be invalid or unenforceable, the remainder of this lease, or any extension thereof, or the application of such term, covenant or condition to persons or circumstances other than those as to which it is held invalid or unenforceable, shall not be affected thereby and each term, covenant or condition of this lease shall be valid and be enforced to the fullest extent permitted by law.
25. **Holding Over.** Any holding over after the expiration of the term thereof, with or without the consent of COUNTY, shall be construed to be a tenancy from month to month at the rents herein specified (prorated on a monthly basis) and shall otherwise be on the terms and conditions herein specified, so far as applicable.
26. **Successors.** All rights and liabilities herein given to, or imposed upon, the respective parties hereto shall extend to and bind the several respective heirs, executors,

administrators, successors and assigns of the said parties; and if there shall be more than one tenant, they shall all be bound jointly and severally by the terms, covenants and agreements herein. No rights, however, shall inure to the benefit of any assignee of CSED unless the assignment to such assignee has been approved by COUNTY in writing as provided herein.

27. Right to Terminate.

a. Notwithstanding any other provision of this lease to the contrary, either party shall have the right to terminate this lease during the initial term or any extension term by giving at least sixty (60) days prior written notice of termination to the other party, by abiding by paragraph 22, page eight (8) of this agreement pertaining to all notices.

b. In the event the Illinois Department of Public Aid or its assigns or successors terminates the agreement of cooperation under which CSED is empowered to perform its duties, CSED and or the County shall have the option to terminate this lease with thirty (30) days written notice to the other.

28. Non-Affiliation Clause. No member of the McLean County Board or any other COUNTY official shall have an interest in any contract let by the McLean County Board either as a contractor or subcontractor pursuant to Illinois Compiled Statutes, 50 ILCS 105/3, et seq.

IN WITNESS WHEREOF, the parties hereto have executed this agreement by their respective officers, there unto duly authorized at Bloomington, Illinois, this 21st day of October, 2003.

APPROVED:

McLean County States Attorney

COUNTY OF McLEAN

By: William A. Yoder, McLean County States Attorney

By: Michael F. Sweeney, Chairman of the McLean County Board

ATTEST:

By: _____

By: Peggy Ann Milton, Clerk of the McLean County Board

McLEAN COUNTY

Fiscal Year 2004 Recommended Budget

Fund:	General 0001	Department:	Parks and Recreation - 0040	Pages:	105 -- 108
CATEGORY	FY 2002 BUDGET	FY 2003 BUDGET	RECOMMENDED FY 2004 BUDGET	AMOUNT OF INCREASE	% INCREASE OVER FY 2003
Revenue	\$ 213,250	\$ 264,350	\$ 255,650	\$ (8,700)	-3.29%
Salaries	\$ 252,663	\$ 248,465	\$ 258,074	\$ 9,609	3.87%
Fringe Benefits	\$ 11,497	\$ 12,751	\$ 14,000	\$ 1,249	9.80%
Materials & Supplies	\$ 42,175	\$ 48,025	\$ 44,625	\$ (3,400)	-7.08%
Contractual	\$ 64,450	\$ 71,850	\$ 79,700	\$ 7,850	10.93%
Capital Outlay	\$ 12,725	\$ 725	\$ 15,250	\$ 14,525	2003.45%
Other	\$ -	\$ -	\$ -	\$ -	N/A
TOTAL:	\$ 383,510	\$ 381,816	\$ 411,649	\$ 29,833	7.81%

Please see attached highlights of the Recommended Budget.

McLean County
Fiscal Year 2004 Recommended Budget

Fund: General 0001

Department: Parks and Recreation 0040

REVENUE:

410.0005 Camp Ground Fees: This revenue line item account has increased from \$116,000 in the FY'2003 Adopted Budget to \$123,000 in the FY'2004 Recommended Budget. This increase is based on a review of the year to date revenue, as of the date the Recommended Budget was prepared. This increase in revenue is a direct result of usage. No campground fee increase is proposed in the FY'2004 Recommended Budget.

410.0050 Boat Registration: This revenue line item account has been decreased from \$68,000 in the FY'2003 Adopted Budget to \$52,000 in the FY'2004 Recommended Budget. This decrease is based on a review of the year to date revenue, as of the date the Recommended Budget was prepared.

410.0013 Donations: This revenue line item account has increased from \$200 in the FY'2003 Adopted Budget to \$500 in the FY'2004 Recommended Budget. This increase is based on a review of last year's actual revenues and the year to date revenue, as of the date the Recommended Budget was prepared.

450.0011 Transfer from Other Funds: This revenue line item account was added in the FY'2003 Adopted Budget. The proposed transfer of \$15,000 comes from the Solid Waste Management Fund 0159. The Parks and Recreation Department maintains a compost area that is used by local schools and community organizations as a resource to learn about recycling. In addition, the Parks and Recreation Department offers outdoor education in conservation, resource management, and recycling. In order to offset the department's expense for these programs, a transfer from the Solid Waste Management Fund has again been included in the FY'2004 Recommended Budget.

(2)

EXPENDITURES:

Personnel:

There is no change in the FTE Staffing Level in the FY'2004 Recommended Budget.

Materials and Supplies:

All of the Materials and Supplies line item accounts are budgeted either at the same level or less as in the FY'2003 Adopted Budget with the following exceptions:

620.0001 Office Supplies: This line item account has increased from \$1,250 in the FY'2003 Adopted Budget to \$1,750 in the FY'2004 Recommended Budget. This increase is based on a review of last year's actual expenses.

622.0001 Medical/Nursing Supplies: This line item account has increased from \$450 in the FY'2003 Adopted Budget to \$700 in the FY'2004 Recommended Budget. This increase is a direct result of the increased utilization of the campground and park facilities.

625.0001 Buildings/Grounds/Equipment Supplies: This line item account has increased from \$13,000 in the FY'2003 Adopted Budget to \$13,400 in the FY'2004 Recommended Budget. This increase is based on a review of last year's actual expenses and the year to date expenses, as of the date the Recommended Budget was prepared.

Contractual Services:

All of the Contractual Services line item accounts are budgeted either at the same level or less as in the FY'2002 Adopted Budget with the following exceptions:

716.0002 Engineering/Design Services: This line item account has increased from \$8,000 the FY'2003 Adopted Budget to \$15,000 in the FY'2004 Recommended Budget. Included in this proposed increase is \$10,000 for electrical design for renovation of the current campsites and funding for the Route 66 linear park.

(3)

781.0001 Mandatory Fees: This is a new line item account that has been added in the FY'2004 Recommended Budget. This line item account is for the new NPDES fee that was enacted by the State of Illinois as a part of the State's FY'2004 Budget. Previously, local governments were exempt from paying the NPDES fee. As a result of the changes made during the review and adoption of the State's budget, all local governments are now required to pay an NPDES fee to the State of Illinois. Since COMLARA Park operates a sanitary wastewater treatment facility at the Park, Parks and Recreation is mandated by State law to pay an annual NPDES fee of \$1,500.

Capital Outlay:

838.0001 Purchase of Machinery and Equipment: This line item account includes funding to purchase the following capital equipment: new lawn mower.

McLEAN COUNTY

Fiscal Year 2004 Recommended Budget

CATEGORY	Fund:	Evergreen Lake	Department:	Parks and Recreation - 0040	RECOMMENDED FY 2004 BUDGET	AMOUNT OF INCREASE	% INCREASE OVER FY 2003
		Lease Fund - 0147					
		FY 2002 BUDGET	FY 2003 BUDGET				
Revenue	\$	17,000	\$ 18,546	\$	18,919	\$ 373	2.01%
Salaries	\$	8,684	\$ 10,230	\$	10,230	-	0.00%
Fringe Benefits	\$	-	\$ -	\$	-	-	N/A
Materials & Supplies	\$	5,565	\$ 5,316	\$	5,689	\$ 373	7.02%
Contractual	\$	2,100	\$ 3,000	\$	3,000	-	0.00%
Capital Outlay	\$	-	\$ -	\$	-	-	N/A
Other	\$	651	\$ -	\$	-	-	N/A
TOTAL:	\$	17,000	\$ 18,546	\$	18,919	\$ 373	2.01%

Please see attached highlights of the Recommended Budget.

McLean County
Fiscal Year 2004 Recommended Budget

Fund: Evergreen Lake Lease Fund 0147 Department: Parks & Recreation 0040

The Evergreen Lake Lease Fund 0147 is a Special Revenue Fund, which must be balanced within the Fund. The Fund was established to promote conservation and development of natural resources within the Park.

REVENUE:

404.0020 Ag/Conservation: The FY'2004 Recommended Budget projects no change in the Ag/Conservation Revenue from the FY'2003 Adopted Budget.

407.0080 Forestry Cost Share: The FY'2004 Recommended Budget projects no change in the Forestry Cost Share Revenue from the FY'2003 Adopted Budget.

400.0000 Unappropriated Fund Balance: The FY'2004 Recommended Budget includes an appropriation of \$1,919 from the Unappropriated Fund Balance in order to balance the budget. On December 31, 2002, the Evergreen Lake Lease Fund had an audited Fund Balance equal to \$34,245.00.

EXPENDITURES:

Personnel:

There is no change in the FTE Staffing level in the FY'2004 Recommended Budget. The total FTE Staffing level remains at 0.52 FTE.

(2)

Materials and Supplies:

All of the Materials and Supplies line item accounts have been budgeted in the FY'2004 Recommended Budget at the same as in the FY'2003 Adopted Budget except for the following line-item accounts:

615.0001 Seed: This line item account has been increased from \$451 in the FY'2003 Adopted Budget to \$600 in the FY'2004 Recommended Budget. This increase is based on a review of the year-to-date expenditures as of the date the Recommended Budget was prepared and the anticipated conservation and planting program in FY'2004.

615.0002 Fertilizer and Herbicide: This line item account has been increased from \$3,365 in the FY'2003 Adopted Budget to \$3,589 in the FY'2004 Recommended Budget. This increase is based on the anticipated conservation and planting program in FY'2004.

McLEAN COUNTY

Fiscal Year 2004 Recommended Budget

Fund:	General 0001	Department:	Facilities Management- Juvenile Detention Center	Pages:	112 -- 113
CATEGORY	FY 2002 BUDGET	FY 2003 BUDGET	RECOMMENDED FY 2004 BUDGET	AMOUNT OF INCREASE	% INCREASE OVER FY 2003
Revenue	\$ -	\$ -	\$ -		N/A
Salaries	\$ 53,358	\$ 54,885	\$ 56,858	\$ 1,973	3.59%
Fringe Benefits	\$ 4,207	\$ 4,667	\$ 5,124	\$ 457	9.79%
Materials & Supplies	\$ 13,330	\$ 12,625	\$ 12,535	\$ (90)	-0.71%
Contractual	\$ 100,826	\$ 91,471	\$ 101,950	\$ 10,479	11.46%
Capital Outlay	\$ -	\$ -	\$ 2,000	\$ 2,000	N/A
Other	\$ -	\$ -	\$ -	\$ -	N/A
TOTAL:	\$ 171,721	\$ 163,648	\$ 178,467	\$ 14,819	9.06%

Please see attached highlights of the Recommended Budget.

McLean County
Fiscal Year 2004 Recommended Budget

Fund: General 0001

Department: Facilities Management 0041
Program: Juvenile Detention 0022

Highlights of the Recommended Budget:

EXPENDITURES:

Personnel:

There is no change in the FTE Staffing Level in the FY'2004 Recommended Budget.

Materials and Supplies:

All of the Materials and Supplies line item accounts have been budgeted in the FY'2004 Recommended Budget at the same level or less as in the FY'2003 Adopted Budget.

601.0001 Clothing/Employees: This line item account has increased from \$0 in the FY'2003 Adopted Budget to \$160 in the FY'2004 Recommended Budget. In FY'2004, the Facilities Management staff at the JDC will need to purchase a uniform shirt, winter snowplow clothing and boots.

621.0001 Operational Supplies: This line item account has decreased from \$1,050 in the FY'2003 Adopted Budget to \$1,000 in the FY'2004 Recommended Budget. This decrease is based on a review of last year's actual expenses and the year to date expenses, as of the date the Recommended Budget was prepared.

625.0001 Buildings/Grounds/Equipment Maintenance Supplies: This line item account has decreased from \$5,700 in the FY'2003 Adopted Budget to \$5,500 in the FY'2004 Recommended Budget. This line item account includes funding for

(2)

the following expenses:

- Locks and Replacement Locks:	\$ 1,430.00
- HVAC Filters/Grease/Oil:	\$ 2,450.00
- Grease Trap Maintenance:	\$ 400.00
- Light Bulbs:	\$ 420.00
- Electrical Supplies:	\$ 550.00
- Miscellaneous Building Supplies:	\$ 250.00
Total:	\$ 5,500.00

Contractual:

All Contractual line item accounts have been budgeted at the same level or less as in the FY'2003 Adopted Budget with the following exceptions:

709.0001 Garbage Disposal Services: This line item account has increased from \$1,530 in the FY'2003 Adopted Budget to \$2,000 in the FY'2004 Recommended Budget. This increase is based on the bid and contract awarded by the Board for garbage disposal services provided to the various County facilities.

744.0001 Maintenance Building/Grounds: This line item account has increased from \$6,400 in the FY'2003 Adopted Budget to \$13,100 in the FY'2004 Recommended Budget. This line item account includes funding for the following contractual service expenses:

- Replace AC Compressor	\$ 6,700.00
- Generator Maintenance	\$ 900.00
- Fire Extinguisher Maintenance	\$ 450.00
- Chiller Maintenance	\$ 2,250.00
- Miscellaneous Outside Services	\$ 1,400.00
- Sprinkler Maintenance	\$ 1,400.00
Total:	\$ 13,100.00

(3)

750.0001 Equipment Maintenance Contracts: This line item account has increased from \$18,656 in the FY'2003 Adopted Budget to \$19,500 in the FY'2004 Recommended Budget. This line item account includes funding for the following contractual service expenses:

-	Simplex Fire and Security:	\$18,570.00
-	Simplex Monitoring Service:	\$ 930.00
	Total:	\$19,500.00

795.0001 Electric Service: This line item account has increased from \$41,635 in the FY'2003 Adopted Budget to \$44,100 in the FY'2004 Recommended Budget. This increase is based on a review of last year's actual expenses and the year to date expenses, as of the date the Recommended Budget was prepared.

Capital Outlay:

801.0001 Capital Improvement: This line item account includes funding for the following capital improvement expense:
replacement of worn out carpeting.

McLEAN COUNTY

Fiscal Year 2004 Recommended Budget

Fund:	General 0001	Department:	Facilities Management- Metro Communications Center	Pages:	114 -- 115
CATEGORY	FY 2002 BUDGET	FY 2003 BUDGET	RECOMMENDED FY 2004 BUDGET	AMOUNT OF INCREASE	% INCREASE OVER FY 2003
Revenue	\$ 92,147	\$ 88,340	\$ 89,853	\$ 1,513	1.68%
Salaries	\$ 28,221	\$ 30,984	\$ 31,296	\$ 312	1.01%
Fringe Benefits	\$ 3,837	\$ 4,285	\$ 4,854	\$ 569	13.28%
Materials & Supplies	\$ 14,042	\$ 12,750	\$ 12,750	\$ -	0.00%
Contractual	\$ 46,047	\$ 40,321	\$ 40,953	\$ 632	1.57%
Capital Outlay	\$ -	\$ -	\$ -	\$ -	N/A
Other	\$ -	\$ -	\$ -	\$ -	N/A
TOTAL:	\$ 92,147	\$ 88,340	\$ 89,853	\$ 1,513	1.71%

Please see attached highlights of the Recommended Budget.

McLean County
Fiscal Year 2004 Recommended Budget

Fund: General 0001 Department: Facilities Management 0041 Program: Metro Centralized Communications 0045

Highlights of the Recommended Budget:

REVENUE:

The Facilities Management - Metro McLean County Centralized Communications Center program budget is presented as a self-balancing program within the General Fund in the FY'2004 Recommended Budget. The program's revenue fully funds the projected maintenance and operating expenses of the Metro McLean County Centralized Communications Center.

The revenue source is the reimbursement received from the Metro McLean County Centralized Communications Center - please see Metro McLean County Centralized Communications Center Fund 0452, Department 0030, Line-item Account 0706.0001 Contract Services. Pursuant to the Intergovernmental Agreement between the Emergency Telephone Systems Board (ETSB), City of Bloomington, Town of Normal, and McLean County, the annual operating budget for the Centralized Communications Center is funded by the three local governments and the ETSB on a per capita formula basis with ETSB assuming 100% funding for the positions and operating expenses which are essential to the operation of a 911 Call Center. Since the MetCom facility was financed and built with proceeds from a Public Building Commission bond issue, the County's Facilities Management Department is responsible for maintenance and custodial services.

EXPENDITURES:

Personnel:

There is no change in FTE Staffing level in the FY'2004 Recommended Budget.

(2)

Materials and Supplies:

All of the Materials and Supplies line item accounts have been budgeted in the FY'2004 Recommended Budget at the same level or less as in the FY'2003 Adopted Budget.

Contractual:

All of the Contractual line item accounts have been budgeted in the FY'2004 Recommended Budget at the same level or less as in the FY'2003 Adopted Budget.

709.0001 Garbage Disposal Services: This line item account has decreased from \$764 in the FY'2003 Adopted Budget to \$600 in the FY'2004 Recommended Budget. This decrease is based on the bid and contract award for garbage disposal services provided to the various County facilities.

744.0001 Maintenance of Buildings/Grounds: This line item account has increased from \$8,278 in the FY'2003 Adopted Budget to \$8,504 in the FY'2004 Recommended Budget. This line item account includes funding for the following expenses:

- UPS Maintenance: \$ 4,754.00
- Fire Extinguisher/Sprinkler Maintenance: \$ 350.00
- Generator Maintenance: \$ 1,400.00
- Outside Contract Services: \$ 2,000.00
- Total: \$ 8,504.00

750.0001 Equipment Maintenance Contracts: This line item account has increased from \$1,125 in the FY'2003 Adopted Budget to \$1,170 in the FY'2004 Recommended Budget. This line item account includes funding for the following expenses:

- Simplex Security/Fire Alarm service: \$1,170.00

795.0001 Electric Service: This line item account has increased from \$28,000 in the FY'2003 Adopted Budget to \$28,500 in the FY'2004 Recommended Budget. This increase is based on a review of the year to date expenses, as of the date Recommended Budget was prepared.

(3)

795.0004 Water Service: This line item account has increased from \$450 in the FY'2003 Adopted Budget to \$475 in the FY'2004 Recommended Budget. This increase is based on a review of last year's actual expenses and the year to date expenses, as of the date the Recommended Budget was prepared.

McLEAN COUNTY

Fiscal Year 2004 Recommended Budget

Fund:	General 0001	Department:	Facilities Management- 200 West Front Street	Pages:	116 -- 117
CATEGORY	FY 2002 BUDGET	FY 2003 BUDGET	RECOMMENDED FY 2004 BUDGET	AMOUNT OF INCREASE	% INCREASE OVER FY 2003
Revenue	\$ 509,092	\$ 492,968	\$ 470,157	\$ (22,811)	-4.63%
Salaries	\$ 100,059	\$ 104,435	\$ 111,012	\$ 6,577	6.30%
Fringe Benefits	\$ 9,200	\$ 10,200	\$ 11,200	\$ 1,000	9.80%
Materials & Supplies	\$ 56,665	\$ 54,265	\$ 54,550	\$ 285	0.53%
Contractual	\$ 257,929	\$ 240,577	\$ 269,080	\$ 28,503	11.85%
Capital Outlay	\$ 85,239	\$ 83,491	\$ 24,315	\$ (59,176)	-70.88%
Other	\$ -	\$ -	\$ -	\$ -	N/A
TOTAL:	\$ 509,092	\$ 492,968	\$ 470,157	\$ (22,811)	-4.63%

Please see attached highlights of the Recommended Budget.

McLean County
Fiscal Year 2004 Recommended Budget

Fund: General 0001
0046

Department: Facilities Management 0041

Program: 200 West Front Street

Highlights of the Recommended Budget:

REVENUE:

The Facilities Management - 200 West Front Street Building program budget is presented as a self-balancing program within the General Fund in the FY'2004 Recommended Budget. The program's anticipated revenue fully funds the projected maintenance and operating expenses of the 200 West Front Street Building.

The primary revenue source is the utilities and maintenance reimbursement received from the Health Department and TB Care and Treatment Clinic. In accordance with the Lease Agreements with the tenants, the FY'2004 Recommended Budget reflects the scheduled increases in the rent payment due the County from the tenants.

The other revenue source is the projected income from renting the parking spaces in the Annex Parking Lot at the corner of Front and Madison Streets.

EXPENDITURES:

Personnel:

There is no change in FTE Staffing level in the FY'2004 Recommended Budget.

(2)

Materials and Supplies:

All of the Materials and Supplies line item accounts have been budgeted in the FY'2004 Recommended Budget at the same level or less as in the FY'2003 Adopted Budget with the following exceptions:

620.0001 Office Supplies: This line item account has increased from \$200 in the FY'2003 Adopted Budget to \$250 in the FY'2004 Recommended Budget. This increase is based on a review of the year to date expenditures, as of the date the Recommended Budget was prepared.

Contractual:

All of the Contractual line item accounts have been budgeted in the FY'2004 Recommended Budget at the same level or less as in the FY'2003 Adopted Budget with the following exceptions:

709.0001 Garbage Disposal Services: This line item account has increased from \$2,300 in the FY'2003 Adopted Budget to \$2,650 in the FY'2004 Recommended Budget. This increase is based on the bid and contract award for providing garbage disposal services to the various County facilities.

744.0001 Maintenance Buildings/Grounds: This line item account is budgeted at the same amount in the FY'2004 Recommended Budget. This line item includes funding for the following expenses:

- Fire Extinguisher Maintenance: \$ 480.00
- Chiller Maintenance: \$4,800.00
- Pump Maintenance: \$2,750.00
- Generator & Electrical Maintenance: \$6,450.00
- Sprinkler Maintenance: \$ 650.00
- Domestic Lift Pump Repair: \$8,000.00
- Total: \$23,130.00

744.0002 CWB Parking Lot Expense: This line item account has been budgeted at \$52,800 in the FY'2004 Recommended Budget. This amount is based on the negotiated lease payment due to the City of Bloomington for the Annex Parking lot.

(3)

750.0001 Equipment Maintenance Contracts: This line item account has increased from \$8,651 in the FY'2003 Adopted Budget to \$9,204 in the FY'2004 Recommended Budget. This line item includes funding for the following expenses:

- Simplex Fire Alarm Maintenance Contract:	\$ 2,694.00
- Simplex Monitoring Security Contract:	\$ 520.00
- Kone Elevator Maintenance Contract:	\$ 5,990.00
Total:	\$ 9,204.00

795.0002 Gas Service: This line item account has decreased from \$33,000 in the FY'2003 Adopted Budget to \$23,000 in the FY'2004 Recommended Budget. This decrease is based on a review of last year's actual expenses and the year to date expenditures, as of the date the Recommended Budget was prepared.

795.0003 Telephone Service: This line item account has decreased from \$1,300 in the FY'2003 Adopted Budget to \$900 in the FY'2004 Recommended Budget. This decrease is based on a review of last year's actual expenses and the year to date expenditures, as of the date the Recommended Budget was prepared.

Capital Outlay:

801.0001 Capital Improvements: This line item account includes funding for any necessary and/or emergency capital improvements that may occur during the year.

McLEAN COUNTY

Fiscal Year 2004 Recommended Budget

Fund:	General 0001	Department:	Facilities Management- Old Courthouse	Pages:	118 -- 120
CATEGORY	FY 2002 BUDGET	FY 2003 BUDGET	RECOMMENDED FY 2004 BUDGET	AMOUNT OF INCREASE	% INCREASE OVER FY 2003
Revenue	\$ 10,000	\$ 133,580	\$ 144,316	\$ 10,736	8.04%
Salaries	\$ 47,174	\$ 48,574	\$ 47,958	\$ (616)	-1.27%
Fringe Benefits	\$ 4,600	\$ 5,100	\$ 5,600	\$ 500	9.80%
Materials & Supplies	\$ 9,870	\$ 7,850	\$ 7,510	\$ (340)	-4.33%
Contractual	\$ 78,196	\$ 72,056	\$ 69,248	\$ (2,808)	-3.90%
Capital Outlay	\$ 28,300	\$ -	\$ 14,000	\$ 14,000	N/A
Other	\$ -	\$ -	\$ -	\$ -	N/A
TOTAL:	\$ 168,140	\$ 133,580	\$ 144,316	\$ 10,736	8.04%

Please see attached highlights of the Recommended Budget.

McLean County
Fiscal Year 2004 Recommended Budget

Fund: General 0001 Department: Facilities Management 0041 Program: Courthouse Maintenance 0049

Highlights of the Recommended Budget:

REVENUE:

420.0010 Historical Society: This revenue line item account reflects the annual rent payment of \$10,000 which the McLean County Historical Society pays to McLean County. The lease between the County and the Historical Society is for a term of 30 years at a fixed annual rent of \$10,000 per year. The lease also stipulates that McLean County shall be responsible for the maintenance and operating expenses of the Old Courthouse.

450.0009 PBC Reimbursement: This revenue line item account was added in the FY'2003 Adopted Budget. Last year, McLean County transferred ownership of the Old Courthouse building and the land to the Public Building Commission (the "PBC"). The PBC will then lease the Old Courthouse Building and the land to the County. Pursuant to the terms of the Lease Agreement, the annual lease expense will be equal to the County's costs for maintaining and operating the Old Courthouse Building. This financing arrangement permits the County to cover the FY'2004 annual maintenance and operating expenses for the Old Courthouse Building. This arrangement also provides the County with several alternatives for financing the necessary improvements to the exterior of the Old Courthouse Building.

The FY'2004 Recommended Budget includes an appropriation of \$134,316 in this line item account. This amount plus the rent paid by the Historical Society will cover the annual maintenance and operating expenses of the Old Courthouse Building.

EXPENDITURES:

Personnel:

There is no change in the FTE Staffing level in the FY'2004 Recommended Budget.

(2)

Materials and Supplies:

All Material and Supplies line item accounts in the FY'2004 Recommended Budget have been budgeted at the same level or less as in the FY'2003 Adopted Budget.

625.0001 Building Equipment Maintenance Supplies: This line item account has been budgeted at \$5,500 in the FY'2004 Recommended Budget. This line item includes funding for the following expenses:

- Data Aire Units: \$ 3,900.00
 - Replacement Filters/Greases: \$ 480.00
 - General Repair Items: \$ 1,120.00
- Total: \$ 5,500.00

Contractual:

All Contractual line item accounts in the FY'2004 Recommended Budget have been budgeted at the same level or less as in the FY'2003 Adopted Budget.

744.0001 Maintenance of Building: This line item account has decreased from \$2500 in the FY'2003 Adopted Budget to \$1500 in the FY'2004 Recommended Budget. This line item includes funding for the following expenses:

- Fire Extinguisher Maintenance: \$ 650.00
 - Outside Contract Services: \$ 850.00
- Total: \$ 1,500.00

750.0001 Equipment Maintenance Contract: This line item account has increased from \$3,561 in the FY'2003 Adopted Budget to \$3,703 in the FY'2004 Recommended Budget. This line item includes funding for the following maintenance contracts: Simplex Fire Alarm System and Kone Elevator Contract.

(3)

795.0001 Electric Service: This line item account has decreased from \$39,000 in the FY'2003 Adopted Budget to \$37,000 in the FY'2004 Recommended Budget. This decrease is based on a review of last year's actual expenses and the year to date expenses at the time the Recommended Budget was prepared.

795.00034 Telephone Service: This line item account has increased from \$510 in the FY'2003 Adopted Budget to \$560 in the FY'2004 Recommended Budget. This increase is based on a review of last year's actual expenses and the year to date expenses at the time the Recommended Budget was prepared.

Capital Outlay:

801.0001 Capital Improvements: This line item account includes funding for the following capital improvement project: relocation and placement of the World War I Memorial Plaque in the Old County Courthouse.